



TEXAS DROVERS



BULL & COMMERCIAL FEMALE SALE

Saturday, December 10, 2022 - 10:00 AM
Caroleta Ranch - Weimar, Texas

SCHEDULE OF EVENTS

Friday, December 9, 2022

8:00 am | Cattle Available for Viewing

12:00 Noon | Lunch Provided by United Ag Coop

1:00-4:00 pm | Cattleman's Field Day

Presentations on LRP Insurance, Nutrition, Cattle Markets & Calf Marketing Program

6:00 pm | Steak Supper Provided by Sponsors

Saturday, December 10, 2022

8:00 am | Coffee, Donuts & Cattle Available for Viewing

10:00 am | **BULL SALE** Bulls sell in catalog order: Brangus, Angus, Charolais

12:00 Noon | Commercial females sell at completion of bull sale.

CATTLEMAN'S FIELD DAY

PLEASE JOIN US FOR A SUPER INFORMATIVE CATTLEMAN'S FIELD DAY WITH SESSIONS THAT WILL ILLUMINATE NEW OPPORTUNITIES IN THE CATTLE BUSINESS.

**** SPECIAL FEATURE ****

*GRAND DOOR PRIZE FOR
FIELD DAY ATTENDEES:
\$500 CREDIT TOWARDS
BULL OR FEMALES IN THE
TEXAS DROVERS SALE*

12 Noon Lunch provided by United Ag Coop, El Campo, TX

1:00 pm Opening Remarks - Joe Fuller & Bunge Halla

Livestock Risk Protection - Tom Kelly, Wiese Crop Insurance

Advanced Mineral Nutrition - Adam Warren, Zinpro

Adding to the Bottom Line with ACP - Michael Grahmann & Bunge Halla, United Ag Coop

Cattle Industry Dynamics - Dr. Jon DeClerck, Purina Animal Nutrition

Cattleman's Panel Discussion - Joe Fuller, Moderator

4:00 pm Grand Prize Drawing for \$500 sale credit

Thank You to Our Sponsors:

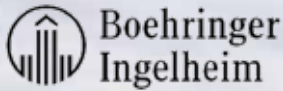

Fellow Drovers:

Welcome to our First Annual Texas Drovers Bull & Commercial Heifer Sale here at Caroleta Ranch south of Weimar, Texas. The genesis of this sale came together with Bunge Halla and Joe Fuller having the desire to create an event where cattlemen can gather and drive to new heights through sharing technology and genetics in order to insure a sustainable future for the cattle industry. We believe in utilizing the most advanced nutritional, management, health, genetic and marketing tools to maximize profits. These beliefs drove us to create an event of like-minded cattle folks that use cutting edge tools like DNA testing, complete performance panels including Ultrasound measurements and advanced reproductive technologies. We are presenting you cattle that have the highest standards of health and nutritional management in place. In other words, come with confidence that you can procure the right kind of genetics at this sale whether you are looking for Brangus, Angus or Charolais bulls or are looking to add high quality and reputation, ranch raised replacement females. The cattle industry is setting up for a huge price surge as we move into 2023 and beyond as demand for high quality beef is driving demand to new heights both domestically and export.

We have some key operations that have made this possible and we know that you will appreciate the cattle that they are presenting to you. American Cattle Enterprise is owned by the Cleveland and Wiley families, and they have operations and cattle in Alabama, Louisiana, Georgia and Texas and they have anchored the Brangus section of the sale with a great set of bulls. In addition, Bradley 3 Ranch of Memphis, Texas is a familiar brand and James & Mary Lou Bradley Henderson along with matriarch Minnie Lou Bradley are bringing to South Texas a strong set of Angus and Charolais bulls. Also, we would like to recognize an up-and-coming Brangus operation, Villa Ranch owned by Milton Villareal and managed by April Villareal who have 10 quality bulls. Another familiar reputation outfit, Kaechele Ranch of Wallis, Texas operated by Frank & Bonnie Reznicek, is the anchor commercial replacement heifer consignor with a choice set of long bred Brangus heifers along with a fancy set of open heifers.

We would also like to invite you to our Field Day on Friday, December 9th starting with lunch at Noon provided by United Ag Coop. In keeping with the theme of the event, we are bringing you information that you take back to your operation and make the right decisions for future profitability. We could not have done this without the great sponsors and our thanks go out to Zinpro, The First State Bank of Louise, Oak Grove Vet Clinic, Oviedo Dodge, Boehringer Ingelheim United Ag Coop and Purina Animal Nutrition. Don't miss the grand prize drawing at the Field Day of a \$500 credit toward to purchase of bulls or females at the sale the next day. You won't want to miss this!

Texas Drovers, a legacy of cattle drovers of old with a keen focus on utilizing cutting edge technology, genetics, nutrition, management, health, finance and marketing to insure that the next generation can still drive the cattle industry along sustainable and profitable trails. We look forward to seeing you at the Field Day and Sale!

Best Regards,
Bunge Halla

Joe W. Fuller



"80 and Sitting Tall" A Bronze of Mr. Les Bunge, grandfather of Bunge Halla and a great Texas Drover.

SALE INFORMATION

SALE DIRECTORS:

Bunge Halla

Texas Drovers | 979-758-4535
1127 Caroleta Ranch Rd., Weimar, TX 78962
www.texasdrovers.com | Bunge67@icloud.com

Joe Fuller

Texas Drovers | 979-255-7747
14148 N State Hwy 16, Willow City, TX 78675
www.texasdrovers.com | joe@texasdrovers.com

CORNERSTONE SEEDSTOCK PROVIDERS:

American Cattle Enterprise

Richard Hood | 979-224-6150
Trey Kirkpatrick | 979-324-5518
Owners - Ricky & Angie Cleveland
Owners - Eric/Kim Wiley
Operations in Louisiana, Georgia & Alabama
848 Jan Street, Oneonta, AL 35121
www.aceglobalbeef.com



Bradley 3 Ranch, Ltd.

James Henderson | 940-585-6171
Mary Lou Henderson | 940-585-6471
Minnie Lou Bradley
15591 CR K, Memphis, TX 79245-5003
www.bradley3ranch.com



BRANGUS BULL SUPPLIERS:

Bad Bitch Cattle Co. - Alex & Liz Johns

Okeechobee, FL | 863.634-6200

Cold Creek Ranch - Tom & Betty Davis

Reynolds, GA | 404-374-3102

G & R Brangus - Larry Galloway & David Roadruck

Larry - Huntsville, AL | 256-603-1945
David - Guntersville, AL | 256-582-1950

Hartness Brangus - Steve Hartness

Limestone, TN | Lee McGarity 706-498-7695

Villa Ranch - Milton Villareal

Brookshire, TX | April Villareal 832-917-7110

CATALOG PRODUCED BY:

Cattle Solutions

Kyle & Crystal Devoll
979-820-8362



VIDEOS PRODUCED BY:

Ideal Video Productions

Wade Fisher
254-319-5349



CLERKING SERVICES PROVIDED BY:

Ranch Hand Analytics

Brad Wright | 979-219-4599

All payments will be made to:

Ranch Hand Analytics
PO Box 12, Hearne, TX 77859



AUCTIONEER:

Doak Lambert | 972-839-6485

SPECIAL GUESTS:

Dr. Darrell Wilkes

Executive Vice President, International Brangus Breeders Association

PUBLICATIONS REPRESENTED:

Angus Journal

Radale Tiner | 979-492-2663

Brangus Journal - Kyle Caldwell

Gulf Coast Cattleman

Charlie Wood | 210-602-1006

Southern Livestock Standard

Michael Sturgess | 210-867-6863

Weekly Livestock Reporter

Ralph Means | 817-235-9708

Special Assignment

Kenny Dolson | 254-485-8454

HOTEL ACCOMMODATIONS:

Holiday Inn Express & Suites

4321 I-10, Columbus, TX | 979-733-9300

La Quinta Inn & Suites

2427 State Hwy 71, Columbus, TX | 979-733-0522

TRUCKING & LOAD OUT:

Korby Halla | 979-758-2243

Trucking will be available sale day and load out available immediately after bull sale and when proper settlement made.

HEALTH PAPERS & BREEDING SOUNDNESS EXAMS:

Health papers will be provided on each lot in the sale suitable for interstate shipment. All bulls have been Trich tested and passed. All bulls selling have passed Breeding Soundness Examinations performed by Veterinarian within 30 days of the sale.

SALE BROADCAST BY:

Wade Fisher
254-319-5349



SALE ORDER:

Bulls will sell in Catalog order from 1 to 154 with bulls selling in this order: Brangus, Angus & Charolais.

The 400 Commercial Females will be sold in groups of 5 to 20 head per lot and sorted by consignor, class and pregnancy status. Cattle will be in pens and individually lot tagged and sold via video in their respective groups. Price paid will be asking price times the number in the group sold. Specific lot numbers and group numbers available at sale time.

BRANGUS DATA KEY

Lot Number → **3**

ACE NOCONA 535J12 CAPC
 AMERICAN CATTLE ENTERPRISE DDF
 R10476143 • 535J12 • P • GEN: 4 • 3/26/21 • A

Registered Name & Owner followed by Genetic Code (if applicable)

Additional Information: Registration# / Animal ID / Horn-Polled Status / Generation (UB1=50% Brangus, UB2=75% Brangus) / Date of Birth / Service Type (AI, ET, NS)

Two Generation Pedigree →

MC BOULDER 889Z14
 NEVER SURRENDER OF SALACOA 803D9
 R10318183
 MS BRINKS LOMBARDI 803S25
 AMERICUS OF SALACOA 468Y16
MS SALACOA AMERICUS 535C36
 R10305366
 MS SVF CADENCE 535X5

IBBA Expected Progeny Differences: EPD / EPD % Ranking within breed

CEP	BW	WW	YW	MILK	TM	CEM	SC	REA	IMF
4.2	0.9	45	90	14	2	4.65	0.48	0.87	0.03
55%	60%	5%	2%	10%	2%	15%	55%	1%	65%

GROWTH, MILK, & MUSCLE

- Never Surrender sons are among the most popular and desired bulls in the Brangus commercial and purebred world.
- 535J12's maternal brother 535E31 sold to T3 Brangus for \$12,000 in the 2019 bull sale.
- ACE is retaining 1/3 Semen Interest.

Performance Data Followed by HPreg and STAY EPds and Terminal/Fertility Indexes.

ACT BW	ADJ WW	ADJ SC	ADJ REA	ADJ IMF
89	625	33.93	14.75	3.95
HPreg	STAY	TERM	FERT	
10.3	2.54	4.38	1.95	
2%	10%	10%	5%	

EPDs

Expected Progeny Difference (EPDs) is the best estimate of an animal's genetic merit for a particular trait. It takes into account the animals' own performance compared with its contemporaries and the performance of its relatives compared against their contemporaries.

Birth Weight (BW) EPD predicts calf size and calving ease.

Weaning Weight (WW) EPD predicts preweaning growth potential.

Yearling Weight (YW) EPD predicts overall growth potential. Milk EPD predicts the maternal contribution to weaning weight of the calf through milk production, behavior, immunity and other maternal environmental factors.

Scrotal Circumference (SC) EPD predicts not only testicular size of male progeny but also daughters onset of puberty.

Terminal Index (TERM) combines birth weight, weaning weight, milk production, post wean gain, bulls with a +2 index are two standard deviations above the average. Higher numbers are superior to low numbers.

Fertility Index (FERT) combines heifer pregnancy, stayability, days to first calving, mature cow weight, and back fat EPDs into a single number. The index is expressed as a standard deviation from the breed average, meaning that bulls with a +2 index are two standard deviations above the average. Higher numbers are superior to low numbers.

ULTRASOUND EPDs

Ribeye Area (REA) EPD predicts total muscle.

Intramuscular Fat (IMF) EPD predicts % of intramuscular fat which is highly correlated to marbling.

**REA and FT are primary components of USDA YG and marbling is the primary component of USDA QG.*

EPD PERCENTILE RANKINGS

Individual ranking relative to the entire breed population on a specific trait, represented in the form of a percentage, with 1% being best and 99% being worst.

TERMS & CONDITIONS

Bidding

Each animal will be sold to the highest bidder without reserve. The auctioneer will settle any disputes as to bids, and his decision on such matters shall be final.

Terms

Each animal becomes the risk of the purchaser as soon as sold, but it shall be the obligation of the seller to see that animals are fed and cared for until loaded for shipment or until the expiration of 48 hours after the sale, whichever occurs sooner. After 48 hours a maintenance fee of \$5.00 per day will be assessed until pickup.

Sight Unseen Purchases

Buyers may purchase females or bulls through the owners, American Cattle Enterprise, or Bradley 3 Ranch personnel at auction without viewing the cattle. For sight unseen purchases, the buyer has the right of inspection at the time of delivery. If the animal is deemed unsatisfactory, it may be reloaded on the delivery truck and returned to female or bull owners ranch at no obligation to the buyer. All transportation expenses will be the responsibility of the seller. If the animal is deemed unsatisfactory within one week of the purchase, the buyer may at their expense, return the animal to the female owner's ranch for a full refund of the purchase price.

Certificate of Registry

A transferred certificate of registry will be furnished to the purchaser for each registered animal once proper settlement has been made.

Health

Health papers suitable for interstate shipment will be furnished on all animals.

Announcements

Any changes from the information of any kind in this catalog will be provided in a sale day supplement sheet or announced from the auction block and such information shall take precedence over cataloged information.

Breeding Guarantee

- All animals are guaranteed to be breeders with the exception of: a) calves under 12 months of age; b) animals shown by purchaser after sale in which the guarantee (if any) shall be between the seller and the buyer; c) injury or disease occurring after the sale; d) gross negligence or willful misconduct on the part of the purchaser; e) death by any reason.
- All bulls, including yearlings, have been tested as clear for Trichomoniasis.
- Safe in calf females have been examined by competent personnel and are so guaranteed.

4. Exposed females have been exposed but are not guaranteed to be safe in calf.

5. Open females have not been served and are so guaranteed.

6. This is not a life insurance policy. Seller will not replace a dead animal if it is killed or dies for any reason. We would suggest that normal care still needs to be exercised toward these animals and that yearling bulls should be fed so they can continue to develop properly.

Pregnancy Determination

The commercial females in this sale noted safe in calf have been determined pregnant by physical palpation or ultrasound technology.

Options and Privileges of Return or Adjustment

- All claims for adjustment or refund must be made in writing within six months of the sale date.
- In the event an animal is claimed to be a non-breeder, the animal may be returned to owner's ranch, if in good condition and complying with the health requirements of their state. The seller shall be entitled to a six month trial following the return of the animal in which to prove that the animal is a breeder. If at the end of six months the seller is unable to prove the animal is a breeder, the seller shall at the option of the buyer replace the animal with another of equal value or issue a credit for the initial selling price. If the seller proves the animal to be a breeder, it shall be the obligation of the purchaser to take delivery of the animal and pay all expenses incurred for transportation.
- If an animal is sold and at a later date proves not to be eligible for registration under association rules, the seller shall be obligated to make a satisfactory adjustment on the purchase price to the buyer, refund the purchase price or issue a credit for the initial selling price upon the return of the animal to the farm of the seller.
- If an animal is sold and through DNA is proven to have incorrect parentage as represented by the certificate of registration, and for which the parentage can be determined, the seller shall be obligated to make a satisfactory adjustment on the purchase price to the buyer, refund the purchase price or issue a credit for the initial selling price upon the return of the animal to the farm of the seller.

Rights and Obligations

- The above terms and conditions of sale shall constitute a contract between the buyer and seller of each animal and shall be equally binding on both. Other than the guarantees and warranties stated above, no other warranties or guarantees are expressed or implied. Each sale or resale of an animal constitutes a separate transaction.
- Neither Texas Drovers staff nor any other person connected with the management of the sale, assumes any liability, legal or otherwise.

BRANGUS BULLS

American Cattle Enterprise is honored to be part of the 1st Annual Texas Drovers Bull Sale. As most know ACE is a partnership established by ranching and farming families the Wileys and the Cleavelands. The partnership was founded by the acquisition of two of the most prominent Brangus herds in the business, Salacoa Valley Farms and Blackwater Cattle Company. With that said, the depth in our genetics is based by over 30 years of intensive breeding and selection of all weights and measures as well as today's DNA technology.

Our bulls were shipped to Weimar, TX at weaning and have been developed there through yearling age and to sale time. They have been professionally conditioned and not over done to insure that they have a long productive life for you the buyer. Our commitment to the Drovers Sale is long lasting. With that said, we have a national and global presence, and we plan to offer our bulls year after year here at the Texas Drovers.

We want to give a special thanks to Bunge and Korby Halla for their great work in developing these bulls. They know them through and through, so if you have any questions, I encourage to give them or myself a call.

Sincerely,
 Richard Hood
 Executive Director
 American Cattle Enterprise
 979.224.6150

OUTSTANDING NEVER SURRENDER

- Never Surrender has sired as many high valued cattle as any bull in the breed the last 4 years and he is one of the trait leaders for growth and red meat. Quannah is the right kind, right sized, clean made and has all the pieces for a strong herd sire prospect.
- Quannah follows his daddy's strength with Top 10% rankings in WW & YW along with a Top 5% score on REA. You will really like his Top 15% Terminal index along with Heifer Preg of Top 4%. 23J25's dam 23C38 post a 366 day calving interval after 5 calves.

ACE is retaining 1/3 Semen Interest.



LOT 1 SIRE NEVER SURRENDER OF SALACOA 803D9

CED	BW	WW	YW	MILK	TM	CEM	SC	REA	IMF
4.6	1.3	43	76	2	30	4.62	0.76	0.66	0.13
50%	70%	10%	10%	95%	30%	20%	30%	5%	40%
ACT BW	ADJ WW	ADJ SC	ADJ REA	ADJ IMF	HPreg	STAY	TERM	FERT	
80	613	34.77	13.01	4.3	8.75	1.83	3.68	0.99	
					4%	20%	15%	30%	



1 ACE QUANAH 23J25

DDF

AMERICAN CATTLE ENTERPRISE

R10476140 • 23J25 • P • GEN: 4 • 3/22/21 • A

MC BOULDER 889Z14

MC SOMETHING SPECIAL 129W14
 MC MS EXTRAVAGANST 889X4

NEVER SURRENDER OF SALACOA 803D9

R10318183

MS BRINKS LOMBARDI 803S25

LOMBARDI OF BRINKS 468N10
 MISS BRINKS KO 803J

STATESBORO OF SALACOA 209Y10

LAMBERT OF BRINKS 317R3
 MS BRINKS BRIGHT SIDE 209L11

MS SALACOA STATESBORO 23C38 R10293663

MS SVF UPPERCUT 23X5

UPPERCUT OF BRINKS 14J8
 SVF LEAD GUN 23 T726

PROFITABLE BUSINESS LINE

- This could very well be the very best Business Line son offered in the Brangus breed. That is a mighty big statement, but when you see Claymore, you will have to agree. He has that extra extension and scale, with a super long level hip and can travel with the best of them.
- Folks have been looking for that Business Line son with extra demension along with EPD's in Top 1% YW and REA along with Top %5 or better WW, SC and Terminal Index while still Top 10% in Fertility Index. His dam has already produced a \$10,000 son and is going into the Donor pen this fall as has every dam in his 3 generation pedigree been a donor...that is cow power behind this herd sire prospect.



LOT 2 COLD CREEK CLAYMORE 240J



LOT 2 SIRE SUHN'S BUSINESS LINE 30D26

CED	BW	WW	YW	MILK	TM	CEM	SC	REA	IMF
0.6	1.8	46	95	7	10	2.31	1.31	0.86	0.16
90%	80%	4%	1%	65%	10%	85%	5%	1%	35%
ACT BW	ADJ WW	ADJ SC	ADJ REA	ADJ IMF	HPreg	STAY	TERM	FERT	
83	657	38.88	14.76	4.06	5.89	1.95	4.83	1.85	
					20%	15%	3%	10%	



COLD CREEK CLAYMORE 240J

DDF

COLD CREEK RANCH

R10485204 • 240J • P • GEN: 2 • 2/4/21 • A

VF-OAKS ONLINE 918Y3

MC ONSTAR 924W4

VOREL MS AFFIRMED 918U4

SUHN'S BUSINESS LINE 30D26 R10327046

SUHN'S MISS NORTH STAR 30A

CRC NORTH STAR 9U8W3

SUHN'S MISS PATTON 30X5

MC BOULDER 889Z14

MC GRANITE 834B

MC MS 778 TRAVELER 834Z

COLD CREEK MS GRANITE 240E2 R10349649

OAKS MS NEXT STEP 240Z2

SUHN'S NEXT STEP 331R7

OAKS MS CSONKA 240U5



ACE NOCONA 535J12

CAPC
DDF

AMERICAN CATTLE ENTERPRISE

R10476143 • 535J12 • P • GEN: 4 • 3/26/21 • A

MC BOULDER 889Z14

NEVER SURRENDER OF SALACOA 803D9

R10318183

MS BRINKS LOMBARDI 803S25

AMERICUS OF SALACOA 468Y16

MS SALACOA AMERICUS 535C36

R10305366

MS SVF CADENCE 535X5

GROWTH, MILK, & MUSCLE

- Never Surrender sons are among the most popular and desired bulls in the Brangus commercial and purebred world.
- 535J12's maternal brother 535E31 sold to T3 Brangus for \$12,000 in the 2019 bull sale.
- ACE is retaining 1/3 Semen Interest.

ACT BW	ADJ WW	ADJ SC	ADJ REA	ADJ IMF
89	625	33.93	14.75	3.95
HPreg	STAY	TERM	FERT	
10.3	2.54	4.38	1.95	
2%	10%	10%	5%	

CED	BW	WW	YW	MILK	TM	CEM	SC	REA	IMF
4.2	0.9	45	90	14	2	4.65	0.48	0.87	0.03
55%	60%	5%	2%	10%	2%	15%	55%	1%	65%



LOT 3 ACE NOCONA 535J12



SALACOA EMPIRE 209J17

AMERICAN CATTLE ENTERPRISE

R10475951 • 209J17 • P • GEN: 5 • 4/20/21 • E

TJM THREE D 302A

DMR EMPIRE 795D12

R10323531

MS DMR JETHRO 795Y2

STONEWALL OF RRR 222W6

MS SALACOA STONEWALL 209B6

R10260345

MS BRINKS BRIGHT SIDE 209L11

GROWTH AND MUSCLE

- Out of a super donor cow SVF 209B6
- 209J17's donor dam 209B6 has an average calving interval of 374 days.

ACT BW	ADJ WW	ADJ SC	ADJ REA	ADJ IMF
75 ET	608	31.96	12.16	4.89
HPreg	STAY	TERM	FERT	
9.42	1.36	2.54	0.13	
3%	35%	40%	65%	

CED	BW	WW	YW	MILK	TM	CEM	SC	REA	IMF
2.8	1.3	34	52	2	60	4.22	-0.25	0.39	0.15
70%	70%	20%	40%	95%	60%	25%	>95%	30%	35%



LOT 4 SALACOA EMPIRE 209J17

BRANGUS BULLS



SALACOA BROADWAY 201J3

AMERICAN CATTLE ENTERPRISE

R10476023 • 201J3 • P • GEN: 5 • 3/14/21 • A

HOLLYWOOD OF SALACOA 23A53

T3 BROADWAY 30E

R10367402

MS SALACOA ATLANTA 30B5

BWCC BIG TOWN 192B16

MS SALACOA BIG TOWN 201E6

R10368044

MS SALACOA BRIGHT SIDE 201A2

CALVING EASE, GROWTH & MARBLING

- Broadway 30E sons are popular in sales for their overall depth and substance.
- 201J3 stacks a list of SVF sires, Hollywood, Big Town, and Atlanta

ACT BW	ADJ WW	ADJ SC	ADJ REA	ADJ IMF
65	649	34.24	11.65	4.96
HPreg	STAY	TERM	FERT	
10.28	1.19	2.89	0.19	
2%	40%	30%	65%	

CED	BW	WW	YW	MILK	TM	CEM	SC	REA	IMF
9.5	-1.8	33	51	5	40	2.34	0.51	0.36	0.18
5%	10%	25%	40%	80%	40%	85%	55%	35%	30%



LOT 5 SALACOA BROADWAY 201J3



G&R NEVER SURRENDER 99J2

G & R BRANGUS

R10486154 • 99J2 • P • GEN: 4 • 2/20/21 • E

MC BOULDER 889Z14

NEVER SURRENDER OF SALACOA

803D9

R10318183

MS BRINKS LOMBARDI 803S25

CADENCE OF BRINKS

SVF MS CADENCE 99S19

R10076231

MISS BB NEW BIG EASY 99C9

GROWTH & MUSCLE

- SVF Never Surrender 803D9 son's are truly the most popular Brangus bulls in the country.
- 99J2's dam is an own daughter of the legendary Cadence of Brinks.

ACT BW	ADJ WW	ADJ SC	ADJ REA	ADJ IMF
79 ET	799	38.24	14.11	4.24
HPreg	STAY	TERM	FERT	
8.34	2.22	4.21	1.65	
5%	10%	10%	10%	

CED	BW	WW	YW	MILK	TM	CEM	SC	REA	IMF
2.4	1.6	46	85	16	1	4	0.63	0.8	0.08
75%	75%	4%	3%	10%	1%	35%	40%	2%	50%



SALACOA 99F29 NS 596J

AMERICAN CATTLE ENTERPRISE

R10476104 • 596J • P • GEN: 5 • 4/19/21 • N

NEVER SURRENDER OF SALACOA 803D9

SALACOA N SURRENDER 99F29

R10420247

MS SALACOA WHITFIELD 99Z10

HOLLYWOOD OF SALACOA 23A53

MS SALACOA HOLLYWOOD 596E

R10368035

MS SALACOA PATTON 596Z3

GROWTH & CARCASS

- Never Surrender x Hollywood combination here and that is why the performance is great in this super attractive herd sire prospect.
- Note the big weaning weight and Strong EPD's for REA and Term Index.

ACT BW	ADJ WW	ADJ SC	ADJ REA	ADJ IMF
89	655	35.72	14.64	4.67
HPreg	STAY	TERM	FERT	
8.91	1.56	3.32	0.87	
4%	25%	20%	35%	

CED	BW	WW	YW	MILK	TM	CEM	SC	REA	IMF
1	2.3	37	67	3	40	2.86	0.71	0.68	0.16
85%	90%	15%	15%	90%	40%	70%	35%	5%	35%



LOT 8 SALACOA BRIGHTON 87J12



SALACOA BRIGHTON 87J12

AMERICAN CATTLE ENTERPRISE

R10476030 • 87J12 • P • GEN: 7 • 3/15/21 • N

LAMBERT OF BRINKS 317R3

BRIGHTON OF SALACOA 392A3

R10237050

MS BRINKS NEW ERA 392P51

TCB CATAWBA WARRIOR R532

MS SALACOA WARRIOR 87A3

R10246513

MS BRINKS CEO 87R3

GROWTH & MILK

- Two of 87J12's maternal brothers have sold in previous bull sales and averaged \$9,500
- 87J12's dam is a 87A3 matriarch in the herd.

ACT BW	ADJ WW	ADJ SC	ADJ REA	ADJ IMF
85	579	39.98	13.19	4.71
HPreg	STAY	TERM	FERT	
2.77	0.9	3.27	0.07	
55%	50%	20%	70%	

CED	BW	WW	YW	MILK	TM	CEM	SC	REA	IMF
-1	1.1	22	56	12	30	1.51	1.01	0.44	0.35
95%	65%	55%	30%	20%	30%	95%	15%	25%	15%



SALACOA BROADWAY 392J9

BAD BITCH CATTLE CO

R10476155 • 392J9 • P • GEN: 7 • 3/14/21 • A

HOLLYWOOD OF SALACOA 23A53

T3 BROADWAY 30E

R10367402

MS SALACOA ATLANTA 30B5

WHITFIELD OF BRINKS 209U23

MS SALACOA WHITFIELD 392Y15

R10204852

MS BRINKS NEW ERA 392P51

CALVING EASE, GROWTH & MUSCLE

- Broadway 30E sons are popular in sales for their overall depth and substance.
- 392J9's donor dam 392Y15 is very prolific. She has produced over 20 calves in her lifetime of which 12 sons have sold to auction.

ACT BW	ADJ WW	ADJ SC	ADJ REA	ADJ IMF
65	646	30.14	14.3	4.2
HPreg	STAY	TERM	FERT	
6.5	0.93	3.93	0.08	
15%	50%	10%	70%	

CED	BW	WW	YW	MILK	TM	CEM	SC	REA	IMF
5.7	-1.4	38	71	3	40	2.34	-0.11	0.7	0.18
35%	10%	15%	10%	90%	40%	85%	>95%	4%	30%



LOT 9 SIRE T3 BROADWAY 30E

10
GGP

HH BIG TOWN 68J

HARTNESS BRANGUS
R10467646 • 68J • P • GEN: 2 • 3/13/21 • A

MC NUFF SAID 889T50

BWCC BIG TOWN 192B16
R10266676

BWCC MS REVELATION 192W8

L&W MS THREE D 541D

L&W MS THREE D 68G
R10404716

L&W MS THREE D 68D

CALVING EASE PROSPECT

• This is one interesting herd sire prospect... you love the volume, easy keeping, depth and easy disposition. Some would say soggy best describes him.

ACT BW	ADJ WW	ADJ SC	ADJ REA	ADJ IMF
58	567	35.8	11.96	4.67
HPreg	STAY	TERM	FERT	
10.13	1.55	2.44	0.36	
2%	30%	40%	55%	

CED	BW	WW	YW	MILK	TM	CEM	SC	REA	IMF
9.5	-1.9	15	39	8	75	2.04	0.48	0.16	0.26
5%	5%	80%	65%	55%	75%	90%	55%	65%	20%



LOT 10 SIRE BWCC BIG TOWN 192B16

11
GGP

VILLA'S COMMERCE 103J

VILLA RANCH

R10485395 • 103J • P • GEN: 5 • 7/24/21 • N

DDD WALL STREET 150C

DDD WALL STREET 804E48
R10361041

DDD MIGHTY SHINY 804B64

SG BOTTOMLINE 851K20

TCR YETTA 103D
R10315808

GT MISS YANCEY 103Y

GOOD LOOKING BULL

• If you are looking for a gentle bull with substantial bone, volume and extra look, this Wallstreet pedigree bull is for you. This bull should produce some outstanding calves and replacement females to add to your herd.

ACT BW	ADJ WW	ADJ SC	ADJ REA	ADJ IMF
832		15.39	4.06	
HPreg	STAY	TERM	FERT	
2.45	0.39	2.09	-0.05	
60%	70%	55%	75%	

CED	BW	WW	YW	MILK	TM	CEM	SC	REA	IMF
2.9	1.1	30	51	3	60	0	0.27	0.13	0.02
70%	65%	30%	40%	90%	60%	>95%	80%	70%	70%



LOT 11 VILLA'S COMMERCE 103J

12
GGP

VILLAS EMPIRE 415J

VILLA RANCH

R10498340 • 415J • P • GEN: 5 • 4/27/21 • A

TJM THREE D 302A

DMR EMPIRE 795D12
R10323531

MS DMR JETHRO 795Y2

CSONKA OF BRINKS 30R4

MS DMR CSONKA 415Z9
R10216861

MS BRINKS BRIGHT SIDE 415R23

EMPIRE SON

• Big boned, stout bull here by the very popular Empire sire. He has some of the great donor cows in the Brangus breed in his pedigree both top and bottom.

ACT BW	ADJ WW	ADJ SC	ADJ REA	ADJ IMF
90	402	14.28	3.53	
HPreg	STAY	TERM	FERT	
9.99	1.23	2.6	0.38	
2%	40%	35%	55%	

CED	BW	WW	YW	MILK	TM	CEM	SC	REA	IMF
4.3	1.4	37	61	6	30	3.5	0.81	0.42	-0.01
50%	70%	15%	25%	75%	30%	50%	25%	25%	80%



LOT 12 MATERNAL GRANDDAM MS BRINKS BRIGHT SIDE 415R23

13
GGP

VILLAS MONUMENT 924J13

VILLA RANCH

R10498339 • 924J13 • P • GEN: 1 • 5/28/21 • E

MC BOULDER 889Z14

BWCC MONUMENT 10D7
UB10336225

BWCC MS RESOURCE 10A10

HOLLYWOOD OF SALACOA 23A53

MS DMR HOLLYWOOD 924F16
R10402674

RBM MS JETHRO 924W5

BALANCED MONUMENT

• Here is a right sized bull with the numbers and look you want. Take a look at the balance across all the economically important traits that keep ranchers in the business.

ACT BW	ADJ WW	ADJ SC	ADJ REA	ADJ IMF
80 ET	456	15.53	5.15	
HPreg	STAY	TERM	FERT	
6.95	2.19	3.19	1.22	
15%	15%	25%	25%	

CED	BW	WW	YW	MILK	TM	CEM	SC	REA	IMF
5.7	-0.7	31	54	0	75	1.52	1.33	0.54	0.31
35%	20%	30%	35%	>95%	75%	95%	5%	15%	20%



LOT 13 VILLAS MONUMENT 924J13

BRANGUS BULLS

14



VILLAS MONUMENT 924J14

VILLA RANCH

R10498341 • 924J14 • P • GEN: 1 • 5/30/21 • E

MC BOULDER 889Z14

BWCC MONUMENT 10D7

UB10336225

BWCC MS RESOURCE 10A10

HOLLYWOOD OF SALACOA 23A53

MS DMR HOLLYWOOD 924F16

R10402674

RBM MS JETHRO 924W5

ET BROTHER TO LOT 14

• Take a look at the genomic profile of this 924 Cow Family bull sired by the rock solid Monument. Outstanding Top 35% or better in an unbelievable 12 EPD traits.

ACT BW	ADJ WW	ADJ SC	ADJ REA	ADJ IMF
85 ET	432		16.37	3.95
HPreg	STAY	TERM	FERT	
6.95	2.19	3.19	1.22	
15%	15%	25%	25%	

CED	BW	WW	YW	MILK	TM	CEM	SC	REA	IMF
5.6	-0.7	31	54	0	75	1.52	1.33	0.54	0.31
35%	20%	30%	35%	>95%	75%	95%	5%	15%	20%



LOT 13 & 14 SIRE BWCC MONUMENT 10D7

15



VILLAS CASHFLOW 924J15

VILLA RANCH

UB10498335 • 924J15 • P • GEN: UB2 • 9/28/21 • E

S A V RESOURCE 1441

DMR CASH FLOW 535F30

UB10386538

MS DMR CORONADO 535A8

HOLLYWOOD OF SALACOA 23A53

MS DMR HOLLYWOOD 924F16

R10402674

RBM MS JETHRO 924W5

HERD BULL PROSPECT DELUXE

• Seedstock folks take note of this outstanding fall yearling UB2 Cash Flow son who ranks in Top 10% in WW, YW and REA while also having top tier Fertility traits that hail from the famed 924 Cow Family. The Cowboys will find this one that scanned a 16" REA.

ACT BW	ADJ WW	ADJ SC	ADJ REA	ADJ IMF
85 ET	741		16.04	4.35
HPreg	STAY	TERM	FERT	
7.9	2.2	3.78	1.39	
10%	15%	15%	20%	

CED	BW	WW	YW	MILK	TM	CEM	SC	REA	IMF
3.2	0.1	40	72	0	55	0.56	0.65	0.68	0.19
65%	35%	10%	10%	>95%	55%	>95%	40%	5%	30%



LOT 15 VILLAS CASHFLOW 924J15

16



SALACOA BRIGHTON 201J5

AMERICAN CATTLE ENTERPRISE

R10476096 • 201J5 • P • GEN: 7 • 4/8/21 • N

LAMBERT OF BRINKS 317R3

BRIGHTON OF SALACOA 392A3

R10237050

MS BRINKS NEW ERA 392P51

KENNESAW OF SALACOA 803Y7

MS SALACOA KENNESAW 201B2

R10259465

MS SVF R532 201X

GROWTH, MILK, REA, MARBLING

• Sired by Carcass King Brighton 392A3
• 201J5's dam 201B2 list 5 calves with a 387 day calving interval before leaving the herd.

ACT BW	ADJ WW	ADJ SC	ADJ REA	ADJ IMF
95	762	37.47	15.15	5.03
HPreg	STAY	TERM	FERT	
3.95	0.97	5.55	-0.2	
40%	45%	1%	80%	

CED	BW	WW	YW	MILK	TM	CEM	SC	REA	IMF
-3.3	2.9	53	100	12	1	1.57	0.6	0.84	0.46
>95%	95%	2%	1%	20%	1%	95%	45%	2%	10%



LOT 16 SALACOA BRIGHTON 201J5

17



SALACOA 535F16 STGY 793J4

AMERICAN CATTLE ENTERPRISE

R10476101 • 793J4 • P • GEN: 5 • 4/14/21 • N

DMR STRATEGY 263C6

SALACOA STRATEGY 535F16

R10382069

MS SALACOA PATTON 535A4

BWCC BIG TOWN 192B16

MS SALACOA BIG TOWN 793D12

R10339359

MS SALACOA STATESBORO 793B4

BALANCED EPDS WITH TOP MILK

• Strategy x Big Town

ACT BW	ADJ WW	ADJ SC	ADJ REA	ADJ IMF
91	658	35.21	12.58	4.02
HPreg	STAY	TERM	FERT	
5.54	0.83	2.36	0.46	
25%	50%	45%	50%	

CED	BW	WW	YW	MILK	TM	CEM	SC	REA	IMF
2.7	1	27	48	14	15	2.1	0.55	0.35	0.08
70%	60%	40%	45%	10%	15%	90%	50%	35%	50%



LOT 17 SALACOA 535F16 STGY 793J4

18

GGP

SALACOA STRATEGY 99J12

AMERICAN CATTLE ENTERPRISE

R10476054 • 99J12 • P • GEN: 5 • 3/19/21 • A

TJM CORONADO 535X

DMR STRATEGY 263C6

R10318980

MS CRC CSONKA 263U

NEVER SURRENDER OF SALACOA 803D9

MS SALACOA 99F14

R10381968

MS SALACOA STONEWALL 99A25

TREMENDOUS EPDS AND INDICIES

- Calving ease specialist Strategy 263C6 x a Never Surrender 803D9 daughter packs the best genetics in the Brangus world in one package.
- 99J12's dam 99F14 post a 369 day calving interval after 3 calves.

ACT BW	ADJ WW	ADJ SC	ADJ REA	ADJ IMF
60	648	37.45	11.68	3.97
HPreg	STAY	TERM	FERT	
4.68	1.01	2.73	0.18	
30%	45%	35%	65%	

CED	BW	WW	YW	MILK	TM	CEM	SC	REA	IMF
7.2	-0.4	31	53	10	25	3.77	0.99	0.35	0.11
20%	25%	30%	40%	35%	25%	40%	15%	35%	45%



LOT 18 SALACOA STRATEGY 99J12



LOT 18-20 SIRE DMR STRATEGY 263C6

19

GGP

SALACOA STRATEGY 196J2

AMERICAN CATTLE ENTERPRISE

R10476099 • 196J2 • P • GEN: 6 • 4/12/21 • N

TJM CORONADO 535X

DMR STRATEGY 263C6

R10318980

MS CRC CSONKA 263U

STATESBORO OF SALACOA 209Y10

MS SALACOA STATESBORO 196A

R10251749

MS SVF WARRIOR 196W

CALVING EASE & MILK

- Guaranteed calving ease stacking Strategy 263C6 and Statesboro 196A
- 196J2's dam 196A post a 393 day calving interval after 7 calves.

ACT BW	ADJ WW	ADJ SC	ADJ REA	ADJ IMF
73	583	35.13	11.4	4.01
HPreg	STAY	TERM	FERT	
1.11	0.42	2.26	0.15	
80%	70%	50%	65%	

CED	BW	WW	YW	MILK	TM	CEM	SC	REA	IMF
7.4	-1.3	23	46	13	30	2.01	0.52	0.05	0.09
20%	10%	55%	50%	15%	30%	90%	50%	85%	50%



LOT 20 SALACOA STRATEGY 192J2

20

GGP

SALACOA STRATEGY 192J2

AMERICAN CATTLE ENTERPRISE

R10476118 • 192J2 • P • GEN: 6 • 5/10/21 • N

TJM CORONADO 535X

DMR STRATEGY 263C6

R10318980

MS CRC CSONKA 263U

LAMBERT OF BRINKS 317R3

MS SALACOA LAMBERT 192A3

R10236578

SVF MS 192T2

CALVING EASE & MARBLING

- Guaranteed calving ease stacking Strategy 263C6 and Lambert 317R3
- 192J2's dam is a matriarch in the SVF Herd

ACT BW	ADJ WW	ADJ SC	ADJ REA	ADJ IMF
79	501	32.48	11.11	4.71
HPreg	STAY	TERM	FERT	
0.84	0.53	1.84	0.5	
85%	65%	65%	50%	

CED	BW	WW	YW	MILK	TM	CEM	SC	REA	IMF
5.9	-0.4	11	27	7	90	2.93	0.18	0.03	0.3
30%	25%	90%	90%	65%	90%	70%	85%	85%	20%

21

GGP

SALACOA 535F14 STGY 803J22

AMERICAN CATTLE ENTERPRISE

R10476016 • 803J22 • P • GEN: 7 • 4/25/21 • N

DMR STRATEGY 263C6

SALACOA STRATEGY 535F14

R10382066

MS SALACOA PATTON 535A4

ATLANTA OF SALACOA 488Z

MS SALACOA ATLANTA 803G4

R10420200

MS SALACOA HOLLYWOOD 803C7

BALANCED EPDS

- Strategy x Atlanta
- 803J22 is out of a first calf heifer.

ACT BW	ADJ WW	ADJ SC	ADJ REA	ADJ IMF
72	397	35.06	10.33	4.12
HPreg	STAY	TERM	FERT	
7.24	0.97	1.81	0.96	
10%	45%	65%	30%	

CED	BW	WW	YW	MILK	TM	CEM	SC	REA	IMF
4.6	-0.2	17	38	7	75	2.4	0.88	0.24	0.03
50%	30%	75%	70%	65%	75%	85%	25%	55%	65%

TEXAS DROVERS



BULL & COMMERCIAL FEMALE SALE

BRANGUS BULLS

22



CCR 415E2 ABSOLUTE 302J4

COLD CREEK RANCH

UB10485210 • 302J4 • P • GEN: UB2 • 2/16/21 • N

GMW ABSOLUTE 1912-510

COLD CREEK 510 ABSOLUTE 415E2

UB10363092

COLD CREEK MS MANNING 415C2

OAKS MANNING 30T 541Z71

COLD CREEK MS MANNING 302E5

R10353123

OAKS MS PASSPORT 302B8

DEEP & GOOD

• 302J4's sire has been our top herd sire that traces back to the red hot 1912 cow family that has produced multiple 5 figure bulls and females.

ACT BW	ADJ WW	ADJ SC	ADJ REA	ADJ IMF
83	589	38.88	13.25	3.38
HPreg	STAY	TERM	FERT	
5.33	1.26	2.28	0.7	
25%	35%	45%	40%	

CED	BW	WW	YW	MILK	TM	CEM	SC	REA	IMF
3.4	1.2	27	59	5	60	0	1.38	0.32	-0.06
65%	65%	40%	25%	80%	60%	>95%	4%	40%	90%



LOT 22 CCR 415E2 ABSOLUTE 302J4

23



CCR BUSINESS LINE 392J4

COLD CREEK RANCH

UB10485213 • 392J4 • P • GEN: UB2 • 1/31/21 • A

VF-OAKS ONLINE 918Y3

SUHN'S BUSINESS LINE 30D26

R10327046

SUHN'S MISS NORTH STAR 30A

MAR INNOVATION 251

COLD CREEK MS INNOVATION 392F11

UB10376451

OAKS MS CSONKA 392C50

BUSINESS LINE

• Business Line Son out of a beautiful MAR Innovation daughter. This Ultrablack 2 bull has EPD's in Top 15% ranking in WW, YW, SC, Terminal & Fertility.

ACT BW	ADJ WW	ADJ SC	ADJ REA	ADJ IMF
80	626	37.52	12.76	3.84
HPreg	STAY	TERM	FERT	
4.67	1.67	3.79	1.47	
30%	25%	15%	15%	

CED	BW	WW	YW	MILK	TM	CEM	SC	REA	IMF
2	1.6	38	74	6	25	1.8	1.24	0.62	0.18
80%	75%	15%	10%	75%	25%	95%	10%	10%	30%

24



SALACOA N SURRENDER 488J4

AMERICAN CATTLE ENTERPRISE

R10476133 • 488J4 • P • GEN: 4 • 3/15/21 • A

MC BOULDER 889Z14

NEVER SURRENDER OF SALACOA 803D9

R10318183

MS BRINKS LOMBARDI 803S25

STONEWALL OF RRR 222W6

MS SALACOA STONEWALL 488C

R10286523

MS SALACOA HANNIBAL 488Z10

BIRTH TO YEARLING WITH MILK & MUSCLE

• Never Surrender x Stonewall is a very popular cross.
• 488J4's dam maintained an incredible 366 day calving interval before selling to Lucky Ranch.

ACT BW	ADJ WW	ADJ SC	ADJ REA	ADJ IMF
72	645	34.98	12.96	3.82
HPreg	STAY	TERM	FERT	
9.61	2.08	3.32	1.73	
2%	15%	20%	10%	

CED	BW	WW	YW	MILK	TM	CEM	SC	REA	IMF
7.4	0	36	68	11	10	5.15	0.72	0.63	0.03
20%	35%	20%	15%	30%	10%	10%	35%	10%	65%



LOT 25 SIRE NEVER SURRENDER OF SALACOA 803D9

25



SALACOA N SURRENDER 334J6

AMERICAN CATTLE ENTERPRISE

R10476091 • 334J6 • P • GEN: 4 • 4/1/21 • A

MC BOULDER 889Z14

NEVER SURRENDER OF SALACOA 803D9

R10318183

MS BRINKS LOMBARDI 803S25

CB FINAL CUT 924X

MS SALACOA FINAL CUT 334E.

R10347169

MS SALACOA BRIGHT SIDE 334Z2

GROWTH AND MUSCLE

• Never Surrender sons are among the most popular and desired bulls in the Brangus commercial and purebred world.
• 334J6's dam 334E has an average calving interval of 370 days. After 5 calves.

ACT BW	ADJ WW	ADJ SC	ADJ REA	ADJ IMF
93	504	35.18	13.16	3.53
HPreg	STAY	TERM	FERT	
10.12	1.58	3.25	-0.13	
2%	25%	20%	75%	

CED	BW	WW	YW	MILK	TM	CEM	SC	REA	IMF
1.8	2.6	33	74	5	40	4.07	0.47	0.7	0.02
80%	95%	25%	10%	80%	40%	30%	60%	4%	70%



LOT 26 SIRE ATLANTA OF SALACOA 448Z

26



COLD CREEK ATLANTA 541J8

COLD CREEK RANCH

R10485222 • 541J8 • P • GEN: 6 • 2/2/21 • A

LAMBERT OF BRINKS 317R3

ATLANTA OF SALACOA 488Z

R10210625

MS SVF CADENCE 488X11

SUHN'S AFFIRMED 30T

COLD CREEK MS AFFIRMED 541Z84

R10226743

MS BRINKS GD FORTUNE 541P96

CLEAN MADE

• Atlanta is one of those go to sires because he does so many things well and this bull proves the point.

ACT BW	ADJ WW	ADJ SC	ADJ REA	ADJ IMF
80	633	35.5	11.82	4.42
HPreg	STAY	TERM	FERT	
6.43	0.04	3.03	-0.6	
15%	80%	25%	90%	

CED	BW	WW	YW	MILK	TM	CEM	SC	REA	IMF
2.5	0.6	25	55	8	50	1.78	0.47	0.31	0.27
75%	50%	45%	35%	55%	50%	95%	60%	40%	20%

27 SALACOA BIG TOWN 636J DDF

AMERICAN CATTLE ENTERPRISE
R10478855 • 636J • P • GEN: 4 • 6/1/21 • N

MC NUFF SAID 889T50
BWCC BIG TOWN 192B16
R10266676
BWCC MS REVELATION 192W8
CLVR MARLBORO 99A5
MS SALACOA MARLBORO 636D2
R10353556
MS SALACOA LAMBERT 636Z

BALANCED EPDS
• An own son of the Million dollar producing BWCC Big Town 192B16

ACT BW	ADJ WW	ADJ SC	ADJ REA	ADJ IMF
80	510	35.18	12.75	4.21
HPreg	STAY	TERM	FERT	
9.26	0.64	2.5	0.06	
3%	60%	40%	70%	

CED	BW	WW	YW	MILK	TM	CEM	SC	REA	IMF
5.1	-0.5	23	47	9	50	1.59	0.66	0.4	0.09
40%	25%	55%	50%	45%	50%	95%	40%	30%	50%

28 HH CRUISE 120J

HARTNESS BRANGUS
UB10467649 • 120J • P • GEN: UB2 • 4/2/21 • N

BWCC CRUISE 889Z28
BWCC CRUISE 323D3
UB10349309
BWCC MS ROCK SOLID 323B
MR. L.O.F. 184
MS WF G120
UB10427609
MS L.O.F. 303H

POWER & MUSCLE
• Multi-Generation Ultrablack
• 1.3 REA/CWT

ACT BW	ADJ WW	ADJ SC	ADJ REA	ADJ IMF
88	763	35.62	14.61	4.11
HPreg	STAY	TERM	FERT	
3.92	1.93	2.91	1.32	
40%	20%	30%	20%	

CED	BW	WW	YW	MILK	TM	CEM	SC	REA	IMF
-2.3	3.5	40	62	8	15	0	0.07	0.52	0.14
>95%	>95%	10%	20%	55%	15%	>95%	90%	15%	40%

29 SALACOA N SURRENDER 78J2

AMERICAN CATTLE ENTERPRISE
R10476064 • 78J2 • P • GEN: 4 • 3/24/21 • A

MC BOULDER 889Z14
NEVER SURRENDER OF SALACOA 803D9
R10318183
MS BRINKS LOMBARDI 803S25
HOLLYWOOD OF SALACOA 23A53
MS SALACOA HOLLYWOOD 78D
R10317939
MS SALACOA HANNIBAL 78Z2

GROWTH & MUSCLE
• SVF Never Surrender 803D9 son's are truly the most popular Brangus bulls in the country.
• 78J2's dam 78D post a 377 day calving interval after 4 calves.

ACT BW	ADJ WW	ADJ SC	ADJ REA	ADJ IMF
94	635	36.35	14.82	4.15
HPreg	STAY	TERM	FERT	
10.6	2.14	3.74	1.6	
1%	15%	15%	15%	

CED	BW	WW	YW	MILK	TM	CEM	SC	REA	IMF
2	2.4	41	79	3	30	1.65	0.95	0.92	0.07
80%	90%	10%	5%	90%	30%	95%	20%	1%	55%

30 SALACOA EMPIRE 209J7

AMERICAN CATTLE ENTERPRISE
R10476028 • 209J7 • P • GEN: 1 • 3/15/21 • A

TJM THREE D 302A
DMR EMPIRE 795D12
R10323531
MS DMR JETHRO 795Y2
HOLLYWOOD OF SALACOA 23A53
MS SALACOA HOLLYWOOD 209F35
UB10393406
TTR A5003 U0286 209L11

BIRTH TO YEARLING GROWTH
• DMR Empire 795D12 son's are very popular in commercial an purebred herds alike.
• 209J7's dam 209F35 has an average calving interval of 350 days.

ACT BW	ADJ WW	ADJ SC	ADJ REA	ADJ IMF
78	672	36.78	12.53	4.31
HPreg	STAY	TERM	FERT	
9.33	1.72	3.59	0.66	
3%	25%	15%	45%	

CED	BW	WW	YW	MILK	TM	CEM	SC	REA	IMF
5.1	0.3	47	78	-1	50	2.85	0.86	0.46	0.07
40%	40%	4%	10%	>95%	50%	70%	25%	20%	55%

31 SALACOA EMPIRE 23J24

AMERICAN CATTLE ENTERPRISE
R10476053 • 23J24 • P • GEN: 5 • 3/19/21 • A

TJM THREE D 302A
DMR EMPIRE 795D12
R10323531
MS DMR JETHRO 795Y2
LEGENDS OF BRINKS 541B17
MS SALACOA LEGENDS 23E14.
R10345864
MS SALACOA BRADLEY 23B5

FERTILITY
• DMR Empire 795D12 son's are very popular in commercial an purebred herds alike.
• 23J24's dam 23E14 post a 394 day calving interval after 4 calves and has 2 daughters retained in the herd.

ACT BW	ADJ WW	ADJ SC	ADJ REA	ADJ IMF
72	599	39.15	11.81	4.25
HPreg	STAY	TERM	FERT	
9	2.05	2.18	1.46	
4%	15%	50%	15%	

CED	BW	WW	YW	MILK	TM	CEM	SC	REA	IMF
5.4	0.1	32	43	1	70	3.79	1.19	0.3	0.13
40%	35%	25%	60%	>95%	70%	40%	10%	45%	40%

32 COLD CREEK ATLANTA 222J

COLD CREEK RANCH
R10485202 • 222J • P • GEN: 6 • 2/4/21 • A

LAMBERT OF BRINKS 317R3
ATLANTA OF SALACOA 488Z
R10210625
MS SVF CADENCE 488X11
CB PASSPORT 803Y11
COLD CREEK MS PASSPORT 222C1
R10304409
COLD CREEK MS LTD 222X2

CARCASS & BALANCE
• Sired by the immortal Atlanta of Salacoa 488Z

ACT BW	ADJ WW	ADJ SC	ADJ REA	ADJ IMF
82	640	39.88	12.64	4.16
HPreg	STAY	TERM	FERT	
7.39	0.44	2.96	0.24	
10%	65%	30%	60%	

CED	BW	WW	YW	MILK	TM	CEM	SC	REA	IMF
3.1	0.8	28	48	7	40	2.11	1.26	0.53	0.3
65%	55%	35%	45%	65%	40%	90%	10%	15%	20%

33 SALACOA BIG LAKE 332J8

AMERICAN CATTLE ENTERPRISE
R10476135 • 332J8 • P • GEN: 1 • 3/17/21 • A

BWCC CROSS FIT 541B28
BWCC BIG LAKE 111F4
UB10399796
BWCC MS ROCK SOLID 111C6
WOODSTOCK OF SALACOA 209Z3
MS SALACOA WOODSTOCK 332C7
R10286254
MS SALACOA HANNIBAL 332Z4

BIRTH TO YEARLING WITH MILK, MUSCLE AND MARBLING
• 332J8 post a balanced set of EPDs ranking in the top 35% or better for BW, WW, YW, Milk, CEM, SC, REA & IMF
• An own son of BWCC Big Lake 111F4

ACT BW	ADJ WW	ADJ SC	ADJ REA	ADJ IMF
82	713	37.07	13.35	4.79
HPreg	STAY	TERM	FERT	
4.72	0.63	4.69	-0.31	
30%	60%	4%	80%	

CED	BW	WW	YW	MILK	TM	CEM	SC	REA	IMF
4.5	0	48	70	10	4	4.42	1.51	0.64	0.55
50%	35%	3%	15%	35%	4%	20%	3%	10%	4%



LOT 33 SIRE BWCC BIG LAKE 111F4

BRANGUS BULLS

34
GGP

SALACOA BIG TOWN 23J41

AMERICAN CATTLE ENTERPRISE

R10476108 • 23J41 • P • GEN: 4 • 4/28/21 • N

MC NUFF SAID 889T50

BWCC BIG TOWN 192B16

R10266676

BWCC MS REVELATION 192W8

BRIGHT SIDE OF BRINKS 789G5

MS SALACOA BRIGHTSIDES 23A20

R10235764

SVF CATAWBA 23 W150

CALVING EASE, MILK, GROWTH & CARCASS

- Big Town 192B16 is the #1 AI sire in the Brangus breed. His sons are among the highest averaging in all the bull sales.
- 23J41's dam 23A20 is a 10 year old matriarch producing 8 calves with a 399 day calving interval.

ACT BW	ADJ WW	ADJ SC	ADJ REA	ADJ IMF
80	542	40.99	14.55	4.65
HPreg	STAY	TERM	FERT	
8.43	0.87	3.87	-0.27	
5%	50%	15%	80%	

CED	BW	WW	YW	MILK	TM	CEM	SC	REA	IMF
7.1	-0.5	26	65	12	25	3.29	1.51	0.79	0.26
20%	25%	45%	20%	20%	25%	55%	3%	2%	20%

36
GGP

SALACOA BIG STONE 209J15

AMERICAN CATTLE ENTERPRISE

R10476086 • 209J15 • P • GEN: 5 • 4/5/21 • N

BWCC BIG TOWN 192B16

SALACOA BIG TOWN 535F9

R10382058

MS SALACOA STONEWALL 535Z30

CSONKA OF BRINKS 30R4

MS SALACOA CSONKA 209F27

R10382096

MS SALACOA ATLANTA 209B12

CALVING EASE SPECIALIST

- Lines up Big Town and Csonka.
- 209J15's dam 209F27 has an average calving interval of 383 days after 3 calves

ACT BW	ADJ WW	ADJ SC	ADJ REA	ADJ IMF
60	598	35.64	12.55	5.32
HPreg	STAY	TERM	FERT	
8.13	0.81	2.76	0.13	
10%	50%	35%	65%	

CED	BW	WW	YW	MILK	TM	CEM	SC	REA	IMF
11.3	-2.5	18	35	9	65	2.8	0.76	0.22	0.39
2%	3%	70%	75%	45%	65%	75%	30%	55%	15%



LOT 39 SALACOA STRATEGY 661J

39
GGP

SALACOA STRATEGY 661J

AMERICAN CATTLE ENTERPRISE

R10476044 • 661J • P • GEN: 5 • 3/17/21 • A

TJM CORONADO 535X

DMR STRATEGY 263C6

R10318980

MS CRC CSONKA 263U

BWCC BIG TOWN 192B16

MS SALACOA BIG TOWN 661D7

R10339376

MS SALACOA SPITFIRE 661B2

TREMENDOUS EPDS AND INDICIES

- Sired by calving ease sire DMR Strategy 263C6
- 661J's dam 661D7 has an average calving interval of 394 days after 4 calves

ACT BW	ADJ WW	ADJ SC	ADJ REA	ADJ IMF
72	652	39.07	13.69	4.3
HPreg	STAY	TERM	FERT	
6.27	1.14	3.42	0.42	
20%	40%	20%	55%	

CED	BW	WW	YW	MILK	TM	CEM	SC	REA	IMF
8.8	-1.5	29	60	12	20	3.28	1.3	0.47	0.2
10%	10%	35%	25%	20%	20%	60%	5%	20%	30%

35
GGP

SALACOA BROADWAY 99J17

AMERICAN CATTLE ENTERPRISE

R10476090 • 99J17 • P • GEN: 8 • 4/1/21 • A

HOLLYWOOD OF SALACOA 23A53

T3 BROADWAY 30E

R10367402

MS SALACOA ATLANTA 30B5

BRAGG OF RRR 795W11

MS SALACOA BRAGG 99F16

R10381976

MS SALACOA ATLANTA 99B25

GROWTH & MUSCLE

- Broadway 30E sons are popular in sales for their overall depth and substance.
- 99J17's dam 99F16 post a 378 day calving interval after 3 calves.

ACT BW	ADJ WW	ADJ SC	ADJ REA	ADJ IMF
96	648	42.48	12.51	3.66
HPreg	STAY	TERM	FERT	
9.92	1.02	2.85	1.09	
2%	45%	30%	30%	

CED	BW	WW	YW	MILK	TM	CEM	SC	REA	IMF
-4	3.6	45	71	1	35	2.01	1.94	0.42	-0.01
>95%	>95%	5%	10%	>95%	35%	90%	1%	25%	80%

37
GGP

SALACOA ATLANTA 209J76

AMERICAN CATTLE ENTERPRISE

R10476046 • 209J76 • P • GEN: 6 • 3/17/21 • A

LAMBERT OF BRINKS 317R3

ATLANTA OF SALACOA 488Z

R10210625

MS SVF CADENCE 488X11

HOLLYWOOD OF SALACOA 23A53

MS SALACOA HOLLYWOOD 209F5

R10381921

MS SALACOA STONEWALL 209B21

CALVING EASE MATERNAL

- Sired by the immortal Atlanta of Salacoa 488Z
- 209J76's dam 209F5 has an average calving interval of 366 days.

ACT BW	ADJ WW	ADJ SC	ADJ REA	ADJ IMF
71	647	37.87	13.08	3.28
HPreg	STAY	TERM	FERT	
8.75	0.9	2.89	0.78	
4%	50%	30%	40%	

CED	BW	WW	YW	MILK	TM	CEM	SC	REA	IMF
4.9	-0.7	31	54	1	75	1.48	1	0.53	0.12
45%	20%	30%	35%	>95%	75%	95%	15%	15%	45%

38
GGP

SALACOA EMPIRE 23J29

AMERICAN CATTLE ENTERPRISE

R10476066 • 23J29 • P • GEN: 5 • 3/24/21 • A

TJM THREE D 302A

DMR EMPIRE 795D12

R10323331

MS DMR JETHRO 795Y2

ATLANTA OF SALACOA 488Z

MS SALACOA ATLANTA 23F6

R10381841

MS SALACOA STONEWALL 23D5

GROWTH & MUSCLE

- DMR Empire 795D12 son's are very popular in commercial an purebred herds alike.
- 23J29's dam 23D65 post a 394 day calving interval after 3 calves.

ACT BW	ADJ WW	ADJ SC	ADJ REA	ADJ IMF
87	631	32.65	13.04	4.03
HPreg	STAY	TERM	FERT	
10.58	1.89	2.88	1.18	
1%	20%	30%	25%	

CED	BW	WW	YW	MILK	TM	CEM	SC	REA	IMF
2.6	1.2	40	59	5	30	3.62	0.03	0.57	0.08
75%	65%	10%	25%	80%	30%	45%	95%	10%	50%

40
GGP

SALACOA BROADWAY 541J30

AMERICAN CATTLE ENTERPRISE

R10476089 • 541J30 • P • GEN: 7 • 3/22/21 • A

HOLLYWOOD OF SALACOA 23A53

T3 BROADWAY 30E

R10367402

MS SALACOA ATLANTA 30B5

AMERICUS OF SALACOA 468Y16

MS SALACOA AMERICUS 541D12

R10330439

SVF SINGLETARY 708 W127

CALVING EASE

- Broadway 30E sons are popular in sales for their overall depth and substance.

ACT BW	ADJ WW	ADJ SC	ADJ REA	ADJ IMF
83	672	33.77	12.56	3.97
HPreg	STAY	TERM	FERT	
9.35	1.68	1.5	1.75	
3%	25%	75%	10%	

CED	BW	WW	YW	MILK	TM	CEM	SC	REA	IMF
3.8	0.2	27	36	6	55	1.69	0.3	0.27	-0.03
60%	40%	40%	75%	75%	55%	95%	75%	50%	85%

41



SALACOA 23G75 NV 541J31 DDF

AMERICAN CATTLE ENTERPRISE

R10476107 • 541J31 • P • GEN: 6 • 4/28/21 • N

NEW VISION OF SALACOA 209Y2

SALACOA NEW VISION 23G75

R10429949

MS SALACOA PATTON 23Z58

SUHN'S CHISHOLM 331W45

MS SALACOA CHISHOLM 541A3

R10249085

MS DMR GUARDIAN 541X14

BALANCED EPDS

• 541J31's 5 maternal brothers have averaged \$6,250

ACT BW	ADJ WW	ADJ SC	ADJ REA	ADJ IMF
81	529	35.29	11.45	5
HPreg	STAY	TERM	FERT	
4.64	0.83	2.32	0.84	
30%	50%	45%	35%	

CED	BW	WW	YW	MILK	TM	CEM	SC	REA	IMF
3.5	0.8	15	41	0	>95	3.15	0.5	0.18	0.31
60%	55%	80%	65%	>95%	>95%	60%	55%	65%	20%

43



SALACOA 535F14 STGY 803J19

AMERICAN CATTLE ENTERPRISE

R10476013 • 803J19 • P • GEN: 7 • 4/14/21 • N

DMR STRATEGY 263C6

SALACOA STRATEGY 535F14

R10382066

MS SALACOA PATTON 535A4

TINSELTOWN OF SALACOA 468D4

MS SALACOA TINSELTOWN 803G18

R10420217

MS SALACOA BIG CYPRESS 803D

FERTILITY AND MATERNAL

• Strategy x Tinseltown
• 803J19 is out of a first calf heifer.

ACT BW	ADJ WW	ADJ SC	ADJ REA	ADJ IMF
70	428	36.11	11.84	4.44
HPreg	STAY	TERM	FERT	
7.01	1.7	1.77	1.18	
15%	25%	65%	25%	

CED	BW	WW	YW	MILK	TM	CEM	SC	REA	IMF
2.4	0.2	12	38	5	95	2.91	0.81	0.16	0.07
75%	40%	85%	70%	80%	95%	70%	25%	65%	55%

45



SALACOA ATLANTA 007J5 CAPC

AMERICAN CATTLE ENTERPRISE

R10476078 • 007J5 • P • GEN: 5 • 3/27/21 • A

LAMBERT OF BRINKS 317R3

ATLANTA OF SALACOA 488Z

R10210625

MS SVF CADENCE 488X11

NEW VISION OF SALACOA 209Y2

MS SALACOA NEW VISION 007E7

R10368007

MS SALACOA WHISKEY 007A5

MATERNAL WITH MUSCLE

• The 007 cow family is a recent generational family that was created by crossing the best of V8 Brahman and Sitz Angus.
• 007J5's dam 007E7 post a 375 day calving interval after 3 calves

ACT BW	ADJ WW	ADJ SC	ADJ REA	ADJ IMF
81	643	33.78	12.77	4.29
HPreg	STAY	TERM	FERT	
7.33	0.25	2.93	0.27	
10%	75%	30%	60%	

CED	BW	WW	YW	MILK	TM	CEM	SC	REA	IMF
3.2	0.2	34	52	7	30	1.26	0.24	0.54	0.18
65%	40%	20%	40%	65%	30%	>95%	80%	15%	30%

47



DBL S BUSINESS LINE 222J2

DOUBLE S RANCH LLC

R10461884 • 222J2 • P • GEN: 6 • 1/12/21 • A

VF-OAKS ONLINE 918Y3

SUHN'S BUSINESS LINE 30D26

R10327046

SUHN'S MISS NORTH STAR 30A

CSONKA OF BRINKS 30R4

CLVR MS CSONKA 222B19

R10276405

MS BRINKS LOMBARDI 222S64

GROWTH & CARCASS

• Sired by Suhn's Business Line 30D26
• 222J2's donor dam 222B19 has been a very productive cow in the Clover herd.

ACT BW	ADJ WW	ADJ SC	ADJ REA	ADJ IMF
84	734	40.29	15.87	5.02
HPreg	STAY	TERM	FERT	
7.11	1.74	3.13	1.38	
15%	20%	25%	20%	

CED	BW	WW	YW	MILK	TM	CEM	SC	REA	IMF
-0.2	2.9	38	68	6	25	2.87	1.21	0.53	0.09
95%	95%	15%	15%	75%	25%	70%	10%	15%	50%

42



SALACOA BIG STONE 803J17

AMERICAN CATTLE ENTERPRISE

R10481980 • 803J17 • P • GEN: 5 • 4/8/21 • N

BWCC BIG TOWN 192B16

SALACOA BIG TOWN 535F9

R10382058

MS SALACOA STONEWALL 535Z30

BWCC BIG TOWN 192B16

MS SALACOA BIG TOWN 803E17

R10369247

MS SVF LAMBERT 803Y2

BALANCED EPDS WITH TOP MILK

• Big Town x Big Town

ACT BW	ADJ WW	ADJ SC	ADJ REA	ADJ IMF
81	680	38.27	12.01	3.86
HPreg	STAY	TERM	FERT	
8.67	0.92	2.05	0.75	
4%	50%	55%	40%	

CED	BW	WW	YW	MILK	TM	CEM	SC	REA	IMF
6.4	-0.6	24	40	13	30	1.86	1.04	0.15	0.07
25%	20%	50%	65%	15%	30%	95%	15%	70%	55%

44



SALACOA ATLANTA 535J27

AMERICAN CATTLE ENTERPRISE

R10475963 • 535J27 • P • GEN: 5 • 4/28/21 • E

LAMBERT OF BRINKS 317R3

ATLANTA OF SALACOA 488Z

R10210625

MS SVF CADENCE 488X11

TCB CATAWBA WARRIOR R532

MS SVF R532 535X4

R10162656

SVF 820R8 535 U066

BALANCED EPDS WITH HUGE MILK

• Sired by the immortal Atlanta of Salacoa 488Z
• 535J25 is out of one of Salacoa Valley's most famous donors 535X4 who has generated over \$100,000 in progeny.

ACT BW	ADJ WW	ADJ SC	ADJ REA	ADJ IMF
78 ET	608	39.99	12.14	4.12
HPreg	STAY	TERM	FERT	
7.36	1.27	2.95	1.48	
10%	35%	30%	15%	

CED	BW	WW	YW	MILK	TM	CEM	SC	REA	IMF
4.1	0.2	31	53	18	4	0.41	1.29	0.46	0.17
55%	40%	30%	40%	3%	4%	>95%	5%	20%	35%

46



SALACOA N SURRENDER 23J34 CAPC

AMERICAN CATTLE ENTERPRISE

R10476079 • 23J34 • P • GEN: 4 • 3/27/21 • A

MC BOULDER 889Z14

NEVER SURRENDER OF SALACOA 803D9

R10318183

MS BRINKS LOMBARDI 803S25

ATLANTA OF SALACOA 488Z

MS SALACOA ATLANTA 23B56

R10273388

MS SVF R532 23X18

MATERNAL & STAYABILITY

• SVF Never Surrender 803D9 son's are truly the most popular Brangus bulls in the country.
• 23J34's dam 23B56 post a 366 day calving interval after 6 calves.

ACT BW	ADJ WW	ADJ SC	ADJ REA	ADJ IMF
93	663	36.48	14.17	3.71
HPreg	STAY	TERM	FERT	
8.94	1.77	4.56	0.98	
4%	20%	4%	30%	

CED	BW	WW	YW	MILK	TM	CEM	SC	REA	IMF
1.4	2.6	51	91	14	1	2.84	0.88	0.87	0.14
85%	95%	2%	2%	10%	1%	70%	25%	1%	40%

48



VILLAS WALLSTREET 74J DDF

VILLA RANCH

R10498338 • 74J • P • GEN: 6 • 10/9/21 • A

DDD WALL STREET 150C

DDD WALL STREET 804E48

R10361041

DDD MIGHTY SHINY 804B64

SALACOA NEW VISION 392B7

DDD MISS DEE DEE 74E3

R10362684

DDD MISS DEE DEE 74B

BALANCED PERFORMANCE

• Take a look at this balanced performance Wallstreet genetics bull.

ACT BW	ADJ WW	ADJ SC	ADJ REA	ADJ IMF
85	547		14.34	4.55
HPreg	STAY	TERM	FERT	
1.98	0.22	2.19	0.42	
70%	75%	50%	55%	

CED	BW	WW	YW	MILK	TM	CEM	SC	REA	IMF
4.8	1.1	31	49	3	60	0	0.17	0.25	0.07
45%	65%	30%	45%	90%	60%	>95%	85%	50%	55%

BRANGUS BULLS



LOT 49 & 50 SIRE TJM THREE D 302A

49



VILLAS THREE D 30J11

VILLA RANCH

R10498334 • 30J11 • P • GEN: 5 • 10/4/21 • E

CB FINAL CUT 924X

TJM THREE D 302A

R10244716

OAKS MS PATTON 302X3

PATTON OF BRINKS 30T22

SUHN'S MISS PATTON 30X6

R10186951

SUHN'S MS DUKE 30M

ELITE ET GENETICS

• Two of the most acclaimed Brangus individuals are the sire and dam of this bull and his full brother in the next lot. Three D and the 30X6 donor have generated untold value in Brangus sales the last 7 years.

ACT BW	ADJ WW	ADJ SC	ADJ REA	ADJ IMF
85 ET	646		12.57	3.87
HPreg	STAY	TERM	FERT	
7.32	1.53	2.58	0.28	
10%	30%	40%	60%	

CED	BW	WW	YW	MILK	TM	CEM	SC	REA	IMF
3.5	0.7	37	65	-2	80	2.89	0.94	0.25	-0.02
60%	50%	15%	20%	>95%	80%	70%	20%	50%	85%

50



VILLAS THREE D 30J10

VILLA RANCH

R10498333 • 30J10 • P • GEN: 5 • 10/1/21 • E

CB FINAL CUT 924X

TJM THREE D 302A

R10244716

OAKS MS PATTON 302X3

PATTON OF BRINKS 30T22

SUHN'S MISS PATTON 30X6

R10186951

SUHN'S MS DUKE 30M

ET BROTHER TO LOT 49

• Another power packed genetic package with some of the all time Brangus greats in his pedigree. Take them both home and make an impact in your herd.

ACT BW	ADJ WW	ADJ SC	ADJ REA	ADJ IMF
70 ET	577		11.67	3.99
HPreg	STAY	TERM	FERT	
7.32	1.53	2.58	0.28	
10%	30%	40%	60%	

CED	BW	WW	YW	MILK	TM	CEM	SC	REA	IMF
3.8	0.7	37	65	-2	80	2.89	0.94	0.25	-0.02
60%	50%	15%	20%	>95%	80%	70%	20%	50%	85%

52



VILLAS BUSINESS LINE 392J10

VILLA RANCH

R10498336 • 392J10 • P • GEN: 6 • 11/5/21 • E

VF-OAKS ONLINE 918Y3

SUHN'S BUSINESS LINE 30D26

R10327046

SUHN'S MISS NORTH STAR 30A

DMR EMPIRE 795D12

MS DMR EMPIRE 392G18

R10436386

WAT MS FINAL CUT 924X-392D21

YOUNG BULL WITH FUTURE

• Blending Business Line with Empire really worked here and look at the high growth and REA readings. Take him home and watch him grow.

ACT BW	ADJ WW	ADJ SC	ADJ REA	ADJ IMF
82 ET	642		13.67	3.75
HPreg	STAY	TERM	FERT	
7.03	1.65	3.64	1.01	
15%	25%	15%	30%	

CED	BW	WW	YW	MILK	TM	CEM	SC	REA	IMF
1.8	1.5	46	75	4	15	3.02	1.29	0.61	0.11
80%	75%	4%	10%	90%	15%	65%	5%	10%	45%

54



COLD CREEK GRANITE 415J4

COLD CREEK RANCH

R10485215 • 415J4 • P • GEN: 1 • 2/1/21 • A

MC BOULDER 889Z14

MC GRANITE 834B

UB10275960

MC MS 778 TRAVELER 834Z

OAKS MANNING 30T 541Z71

COLD CREEK MS MANNING 415C2

R10304419

MS COLD CREEK/ DMR LTD 415X

STOUT

• Here is a Granite son that will keep a balanced approach with some extra milk. His dam produced a herd sire used within the herd.

ACT BW	ADJ WW	ADJ SC	ADJ REA	ADJ IMF
80	685	39.76	12.76	3
HPreg	STAY	TERM	FERT	
4.28	1.33	2.75	0.86	
35%	35%	35%	35%	

CED	BW	WW	YW	MILK	TM	CEM	SC	REA	IMF
4.7	0.2	33	62	11	15	2.6	1.02	0.33	0.01
45%	40%	25%	20%	30%	15%	80%	15%	40%	75%

51



VILLAS EMPIRE 302J

VILLA RANCH

R10498337 • 302J • P • GEN: 5 • 10/16/21 • A

TJM THREE D 302A

DMR EMPIRE 795D12

R10323531

MS DMR JETHRO 795Y2

LTD OF BRINKS 415T28

MS SALACOA LTD 30Z2

R10226255

MS BRINKS CADENCE 209P47

CALVING EASE PROSPECT

• This is an Empire son who can follow in his daddy's footsteps by being a calving ease and maternal powerhouse. Note the 78# BW.

ACT BW	ADJ WW	ADJ SC	ADJ REA	ADJ IMF
78	590		14.3	4.46
HPreg	STAY	TERM	FERT	
9.21	0.84	2.63	-0.03	
3%	50%	35%	70%	

CED	BW	WW	YW	MILK	TM	CEM	SC	REA	IMF
6.2	0.1	37	58	8	20	4.35	0.88	0.49	-0.02
30%	35%	15%	30%	55%	20%	25%	25%	20%	85%

53



CCR 1912F GRANITE 541J3

COLD CREEK RANCH

UB10485200 • 541J3 • P • GEN: UB1 • 3/23/21 • N

MC GRANITE 834B

COLD CREEK GRANITE 1912F

UB10402367

COLD CREEK LADY PASSPORT 1912C

RB CONFIRMED 02-4524

CCR MS CONFIRMED 541G10

UB10417660

OAKS MS UNITAS 541W6

POUNDS = \$\$\$

• This Ultrablack bull is at the very top of growth bulls in the breed. He is Top 1% in YW and 2% in WW which means more pay-weight for you.

ACT BW	ADJ WW	ADJ SC	ADJ REA	ADJ IMF
83	688	35.21	14.11	4.08
HPreg	STAY	TERM	FERT	
5.63	1.67	4.53	0.99	
25%	25%	5%	30%	

CED	BW	WW	YW	MILK	TM	CEM	SC	REA	IMF
2.1	1.3	51	98	6	10	0	1.08	0.45	0.1
80%	70%	2%	1%	75%	10%	>95%	15%	25%	45%



LOT 53 SIRE MC GRANITE 834B

55
GGP

SALACOA BIG TOWN 23J36

AMERICAN CATTLE ENTERPRISE

R10476095 • 23J36 • P • GEN: 4 • 4/8/21 • N

MC NUFF SAID 889T50

BWCC BIG TOWN 192B16

R10266676

BWCC MS REVELATION 192W8

STONEWALL OF RRR 222W6

MS SALACOA STONEWALL 23D47

R10317922

MS SALACOA NEW ERA 23Z51

MILK, MATERNAL & IMF

- Big Town 192B16 is the #1 AI sire in the Brangus breed. His sons are among the highest averaging in all the bull sales.
- 23J36's dam 23D47 post a 364 day calving interval after 5 calves.

ACT BW	ADJ WW	ADJ SC	ADJ REA	ADJ IMF
80	701	39.47	12.12	4.51
HPreg	STAY	TERM	FERT	
9.89	2.05	2.68	1.88	
2%	15%	35%	10%	

CED	BW	WW	YW	MILK	TM	CEM	SC	REA	IMF
4.7	0.2	31	38	14	15	2.85	1.31	0.43	0.35
45%	40%	30%	70%	10%	15%	70%	5%	25%	15%

56
GGP

SALACOA 803G70 TT 201J4

AMERICAN CATTLE ENTERPRISE

R10476080 • 201J4 • P • GEN: 7 • 3/27/21 • N

TINSELTOWN OF SALACOA 468D4

SALACOA TINSELTOWN 803G70

R10435849

MS SALACOA BIG CYPRESS 803D

NEW VISION OF SALACOA 209Y2

MS SALACOA NEW VISION 201B

R10258531

IH MS CSONKA 201Y

BW TO YW SPREAD WITH MARBLING

- Sired by the \$45,000 Tinseltown 803G70
- 201J4's dam is a tremendous cow in the SVF herd.

ACT BW	ADJ WW	ADJ SC	ADJ REA	ADJ IMF
71	669	35.48	13.52	4.89
HPreg	STAY	TERM	FERT	
8.05	1.44	3.52	0.99	
10%	30%	15%	30%	

CED	BW	WW	YW	MILK	TM	CEM	SC	REA	IMF
4.2	0.2	35	61	3	55	3.06	0.51	0.53	0.29
55%	40%	20%	25%	90%	55%	65%	55%	15%	20%

57
GGP

SALACOA 99F29 NS 488J9

AMERICAN CATTLE ENTERPRISE

R10476123 • 488J9 • P • GEN: 5 • 5/16/21 • N

NEVER SURRENDER OF SALACOA 803D9

SALACOA N SURRENDER 99F29

R10420247

MS SALACOA WHITFIELD 99Z10

LEGENDS OF BRINKS 541B17

MS SALACOA LEGENDS 488F5

R10393387

MS SALACOA KENNESAW 488C2

GROWTH & MILK

- 488J9's dam 488F5 has an average calving interval of 398 days after 3 calves.

ACT BW	ADJ WW	ADJ SC	ADJ REA	ADJ IMF
85	551	34.83	13.33	3.57
HPreg	STAY	TERM	FERT	
7.39	1.84	2.91	1.27	
10%	20%	30%	20%	

CED	BW	WW	YW	MILK	TM	CEM	SC	REA	IMF
0	2.6	30	67	10	25	3.04	0.58	0.53	0
90%	95%	30%	15%	35%	25%	65%	45%	15%	75%

58
GGP

SALACOA BROADWAY 535J9

AMERICAN CATTLE ENTERPRISE

R10476052 • 535J9 • P • GEN: 7 • 3/19/21 • A

HOLLYWOOD OF SALACOA 23A53

T3 BROADWAY 30E

R10367402

MS SALACOA ATLANTA 30B5

LEGENDS OF BRINKS 541B17

MS SALACOA LEGENDS 535E20

R10348685

MS SALACOA STONEWALL 535A34

BIRTH TO YEARLING SPREAD

- Broadway 30E sons are popular in sales for their overall depth and substance.

ACT BW	ADJ WW	ADJ SC	ADJ REA	ADJ IMF
75	711	37.65	12.92	4.16
HPreg	STAY	TERM	FERT	
9.26	1.3	3.42	1.08	
3%	35%	20%	30%	

CED	BW	WW	YW	MILK	TM	CEM	SC	REA	IMF
7.8	-1.5	41	70	4	30	1.55	1.08	0.3	0.06
15%	10%	10%	15%	90%	30%	95%	15%	45%	55%

59
GGP

HH CRUISE 793J

HARTNESS BRANGUS

NHPC

R10467650 • 793J • P • GEN: 4 • 3/24/21 • A

BWCC CRUISE 889Z28

BWCC CRUISE 323D3

UB10349309

BWCC MS ROCK SOLID 323B

ELC MR TRIBUTE 793C10

L&W MS TRIBUTE 793G2

R10410900

L&W MS UB CHISHOLM 793B2

WEANING WEIGHT

- 793J posted a huge 205 Adj WW of 802 lbs.

ACT BW	ADJ WW	ADJ SC	ADJ REA	ADJ IMF
64	802	33.75	13.5	4.13
HPreg	STAY	TERM	FERT	
5.14	2.16	2.99	1.99	
25%	15%	25%	5%	

CED	BW	WW	YW	MILK	TM	CEM	SC	REA	IMF
3.4	1.2	40	60	8	15	5.23	-0.1	0.33	0.15
65%	65%	10%	25%	55%	15%	10%	>95%	40%	35%

60
GGP

SALACOA BRIGHTON 535J15

AMERICAN CATTLE ENTERPRISE

R10476621 • 535J15 • P • GEN: 5 • 4/1/21 • N

LAMBERT OF BRINKS 317R3

BRIGHTON OF SALACOA 392A3

R10237050

MS BRINKS NEW ERA 392P51

BWCC BIG TOWN 192B16

MS SALACOA BIG TOWN 535D24

R10335372

MS SALACOA STONEWALL 535Z35

BALANCED EPD PROFILE

- Sired by Carcass King Brighton 392A3
- 535J15's dam 535D24 has an average calving interval of 397 days after 4 calves.

ACT BW	ADJ WW	ADJ SC	ADJ REA	ADJ IMF
85	642	36.18	13.52	4.87
HPreg	STAY	TERM	FERT	
7.38	1.35	3.32	0.44	
10%	35%	20%	55%	

CED	BW	WW	YW	MILK	TM	CEM	SC	REA	IMF
0.1	1.2	32	53	7	35	1.94	0.75	0.62	0.38
90%	65%	25%	40%	65%	35%	90%	30%	10%	15%



LOT 60 SIRE BRIGHTON OF SALACOA 392A3



LOT 60 DAM MS SALACOA BIG TOWN 535D24

BRANGUS BULLS

61



SALACOA HOLLYWOOD 36J

AMERICAN CATTLE ENTERPRISE

R10476050 • 36J • P • GEN: 7 • 3/19/21 • A

NEW VISION OF SALACOA 209Y2

HOLLYWOOD OF SALACOA 23A53

R10251840

MS SVF PATTON 23Y66

ATLANTA OF SALACOA 488Z

MS SALACOA ATLANTA 36E3

R10368032

MS SALACOA WHISKEY 36A

BW TO YW SPREAD WITH MUSCLE

- Hollywood sons are known for putting pounds on the ground.
- 36J's dam 36E3 is a tremendous Atlanta daughter.

ACT BW	ADJ WW	ADJ SC	ADJ REA	ADJ IMF
79	627	32.95	13.23	4.05
HPreg	STAY	TERM	FERT	
9.23	1.14	2.58	1.4	
3%	40%	40%	20%	

CED	BW	WW	YW	MILK	TM	CEM	SC	REA	IMF
3	0.4	29	50	-1	90	1.09	0.41	0.56	0.09
70%	45%	35%	45%	>95%	90%	>95%	65%	15%	50%

62



SALACOA BIG STONE 468J11

AMERICAN CATTLE ENTERPRISE

R10476012 • 468J11 • P • GEN: 5 • 4/5/21 • N

BWCC BIG TOWN 192B16

SALACOA BIG TOWN 535F9

R10382058

MS SALACOA STONEWALL 535Z30

TINSELTOWN OF SALACOA 468D4

MS SALACOA TINSELTOWN 468F45

R10413159

MS BRINKS BS 607L11 468S78

CALVING EASE

- 468J11's dam 468F45 has an average calving interval of 392 days after 3 calves.

ACT BW	ADJ WW	ADJ SC	ADJ REA	ADJ IMF
75	444	38.74	12.99	4.13
HPreg	STAY	TERM	FERT	
10.04	1.82	1.39	1.32	
2%	20%	80%	20%	

CED	BW	WW	YW	MILK	TM	CEM	SC	REA	IMF
6.1	-1.4	7	27	5	95	2.84	1.16	0.3	0.04
30%	10%	95%	90%	80%	95%	70%	10%	45%	65%

63



SALACOA BROADWAY 488J6

AMERICAN CATTLE ENTERPRISE

R10476136 • 488J6 • P • GEN: 7 • 3/17/21 • A

HOLLYWOOD OF SALACOA 23A53

T3 BROADWAY 30E

R10367402

MS SALACOA ATLANTA 30B5

KENNESAW OF SALACOA 803Y7

MS SALACOA KENNESAW 488C2

R10287872

MS SALACOA HANNIBAL 488Z5

TREMENDOUS EPDS AND INDICIES

- Broadway 30E sons are popular in sales for their overall depth and substance.
- 488J6's dam 488C2 has an average calving interval of 363 days after 5 calves.

ACT BW	ADJ WW	ADJ SC	ADJ REA	ADJ IMF
81	695	34.07	13.77	4.29
HPreg	STAY	TERM	FERT	
8.64	1.55	4.34	0.92	
4%	30%	10%	35%	

CED	BW	WW	YW	MILK	TM	CEM	SC	REA	IMF
5.4	-0.7	42	83	10	10	1.24	0.57	0.61	0.16
40%	20%	10%	3%	35%	10%	>95%	45%	10%	35%

64



SALACOA 99F29 NS 99J18

AMERICAN CATTLE ENTERPRISE

R10476098 • 99J18 • P • GEN: 5 • 4/12/21 • N

NEVER SURRENDER OF SALACOA 803D9

SALACOA N SURRENDER 99F29

R10420247

MS SALACOA WHITFIELD 99Z10

HOLLYWOOD OF SALACOA 23A53

MS SALACOA HOLLYWOOD 99F20

R10393394

MS SALACOA STONEWALL 99A4

BW TO YW SPREAD WITH MUSCLE

- 99J18 stacks the base of SVF genetics Never Surrender, Whitfield, Stonewall and Hollywood.
- 99J18's dam 99F20 post 369 day calving interval after 3 calves.

ACT BW	ADJ WW	ADJ SC	ADJ REA	ADJ IMF
70	541	37.43	13.2	4.62
HPreg	STAY	TERM	FERT	
8.55	1.56	2.78	1	
5%	25%	30%	30%	

CED	BW	WW	YW	MILK	TM	CEM	SC	REA	IMF
3.8	0.6	26	57	1	80	3.53	0.91	0.6	0.09
60%	50%	45%	30%	>95%	80%	50%	20%	10%	50%

65



SALACOA 23G75 NV 535J17

AMERICAN CATTLE ENTERPRISE

R10476100 • 535J17 • P • GEN: 6 • 4/14/21 • N

NEW VISION OF SALACOA 209Y2

SALACOA NEW VISION 23G75

R10429949

MS SALACOA PATTON 23Z58

HOLLYWOOD OF SALACOA 23A53

MS SALACOA HOLLYWOOD 535D33

R10339391

MS SVF F532 535X4

STELLAR PHENOTYPE

- Stacks the popular Brangus breed sire New Vision 209Y2 multiple times in his pedigree.

ACT BW	ADJ WW	ADJ SC	ADJ REA	ADJ IMF
85	584	36.71	12.51	4.41
HPreg	STAY	TERM	FERT	
6.42	1.25	2.24	1.4	
15%	35%	50%	20%	

CED	BW	WW	YW	MILK	TM	CEM	SC	REA	IMF
2.7	0.8	21	47	0	95	0.78	0.81	0.38	0.11
70%	55%	60%	50%	>95%	95%	>95%	25%	30%	45%

66



SALACOA BIG TOWN 793J3

AMERICAN CATTLE ENTERPRISE

R10476070 • 793J3 • P • GEN: 4 • 3/24/21 • A

MC NUFF SAID 889T50

BWCC BIG TOWN 192B16

R10266676

BWCC MS REVELATION 192W8

BRAGG OF RRR 795W11

MS SALACOA BRAGG 793D6

R10317888

MS SVF WARRIOR 793Y3

TREMENDOUS EPDS AND INDICIES

- An own son of the Million dollar producing BWCC Big Town 192B16
- 793J3's dam post an average 379 day calving interval after 5 calves.

ACT BW	ADJ WW	ADJ SC	ADJ REA	ADJ IMF
68	700	37.85	13.3	4.88
HPreg	STAY	TERM	FERT	
10.62	1.44	3.68	0.77	
1%	30%	15%	40%	

CED	BW	WW	YW	MILK	TM	CEM	SC	REA	IMF
6.9	-0.2	40	59	10	10	3.11	1.22	0.6	0.33
20%	30%	10%	25%	35%	10%	65%	10%	10%	15%

67



SALACOA 535F16 STGY 87J13

AMERICAN CATTLE ENTERPRISE

R10476151 • 87J13 • P • GEN: 7 • 5/22/21 • N

DMR STRATEGY 263C6

SALACOA STRATEGY 535F16

R10382069

MS SALACOA PATTON 535A4

STONEWALL OF RRR 222W6

MS SALACOA STONEWALL 87C6

R10300109

MS SALACOA LAMBERT 87A8

CALVING EASE

- Calving ease is stacked in 87J13's pedigree with Strategy x Stonewall combination.
- 87J13 is out of a tremendous Stonewall daughter 87C6

ACT BW	ADJ WW	ADJ SC	ADJ REA	ADJ IMF
78	563	33.27	12.68	3.19
HPreg	STAY	TERM	FERT	
4.19	0.68	1.56	1	
40%	60%	75%	30%	

CED	BW	WW	YW	MILK	TM	CEM	SC	REA	IMF
5.7	-1	15	35	11	60	3.93	0.37	0.18	-0.04
35%	15%	80%	75%	30%	60%	35%	70%	65%	90%

68



SALACOA BIG STONE 889J2

AMERICAN CATTLE ENTERPRISE

R10476106 • 889J2 • P • GEN: 4 • 4/20/21 • N

BWCC BIG TOWN 192B16

SALACOA BIG TOWN 535F9

R10382058

MS SALACOA STONEWALL 535Z30

MB ANDERSON 99B7

SALACOA ANDERSON 889E.

R10352207

MB MS REVELATION 889C6

BALANCED EPDS WITH BIG MILK

- 889J2's dam 803e maintained an average day calving interval of 379 days after 5 natural calves.

ACT BW	ADJ WW	ADJ SC	ADJ REA	ADJ IMF
85	623	37.96	14.03	4.6
HPreg	STAY	TERM	FERT	
6.45	1.02	2.93	0.51	
15%	45%	30%	50%	

CED	BW	WW	YW	MILK	TM	CEM	SC	REA	IMF
5.5	0	27	50	15	15	2.41	1.07	0.45	0.22
35%	35%	40%	45%	10%	15%	85%	15%	25%	25%

69 SALACOA BRIGHTON 803J23 DDF

GGP RAFTER B RANCH
R10476170 • 803J23 • P • GEN: 7 • 4/28/21 • N

LAMBERT OF BRINKS 317R3
BRIGHTON OF SALACOA 392A3
R10237050
MS BRINKS NEW ERA 392P51

BRAGG OF RRR 795W11
MS SALACOA BRAGG 803A
R10237067
MS SVF LAMBERT 803X

MATERNAL AND LONGEVITY

- Sired by Carcass King Brighton 392A3
- 803J23's dam 803A maintained an incredible average day calving interval of 368 days after 8 natural calves.

ACT BW	ADJ WW	ADJ SC	ADJ REA	ADJ IMF
89	587	34.49	12.69	4.76
HPreg	STAY	TERM	FERT	
4.93	0.92	3.09	0.31	
30%	50%	25%	60%	

CED	BW	WW	YW	MILK	TM	CEM	SC	REA	IMF
-5.7	4	30	59	0	85	3.16	0.27	0.45	0.38
>95%	>95%	30%	25%	>95%	85%	60%	80%	25%	15%

70 SALACOA ATLANTA 535J28

GGP AMERICAN CATTLE ENTERPRISE
R10475948 • 535J28 • P • GEN: 5 • 4/20/21 • E

LAMBERT OF BRINKS 317R3
ATLANTA OF SALACOA 488Z
R10210625
MS SVF CADENCE 488X11

TCB CATAWBA WARRIOR R532
MS SVF R532 535X4
R10162656
SVF 820R8 535 U066

BALANCED EPDS WITH HUGE MILK

- Sired by the immortal Atlanta of Salacoa 488Z
- 535J25 is out of one of Salacoa Valley's most famous donors 535X4 who has generated over \$100,000 in progeny.

ACT BW	ADJ WW	ADJ SC	ADJ REA	ADJ IMF
69 ET	522	38.16	11.24	4.17
HPreg	STAY	TERM	FERT	
7.36	1.27	3.04	1.33	
10%	35%	25%	20%	

CED	BW	WW	YW	MILK	TM	CEM	SC	REA	IMF
4.3	0.2	32	55	18	4	0.42	1.07	0.37	0.18
50%	40%	25%	35%	3%	4%	>95%	15%	30%	30%

71 SALACOA ATLANTA 23J28

GGP BAD BITCH CATTLE CO
R10476157 • 23J28 • P • GEN: 6 • 3/22/21 • A

LAMBERT OF BRINKS 317R3
ATLANTA OF SALACOA 488Z
R10210625
MS SVF CADENCE 488X11

STONEWALL OF RRR 222W6
MS SALACOA STONEWALL 23D65
R10229747
MS SALACOA NEW VISION 23A49

BW TO YW SPREAD WITH CARCASS

- Atlanta x Stonewall has become the one of the most popular Brangus blood crosses in the business.
- 23J28's dam 23D65 post a 383 day calving interval after 4 calves.

ACT BW	ADJ WW	ADJ SC	ADJ REA	ADJ IMF
73	657	37.27	13.16	4.07
HPreg	STAY	TERM	FERT	
8.73	0.9	2.8	0.87	
4%	50%	30%	35%	

CED	BW	WW	YW	MILK	TM	CEM	SC	REA	IMF
4.8	-0.6	32	51	1	65	2.8	0.61	0.56	0.14
45%	20%	25%	40%	>95%	65%	75%	45%	15%	40%

72 CCR 415E2 ABSOLUTE 392J2

GGP COLD CREEK RANCH
UB10485211 • 392J2 • P • GEN: UB2 • 4/30/21 • N

GMW ABSOLUTE 1912-510
COLD CREEK 510 ABSOLUTE 415E2
UB10363092
COLD CREEK MS MANNING 415C2

VF-OAKS ONLINE 918Y3
COLD CREEK MS ONLINE 392E
R10349657
OAKS MS CSONKA 392C50

POWER & MUSCLE

ACT BW	ADJ WW	ADJ SC	ADJ REA	ADJ IMF
82	666	43.87	11.91	3.77
HPreg	STAY	TERM	FERT	
5.16	1.45	2.7	1.34	
25%	30%	35%	20%	

CED	BW	WW	YW	MILK	TM	CEM	SC	REA	IMF
4.3	0.7	34	60	6	35	2.89	2.26	0.05	0.1
50%	50%	20%	25%	75%	35%	70%	1%	85%	45%

73 SALACOA 535F12 STGY 007J3 CAPC

GGP AMERICAN CATTLE ENTERPRISE
AX10476006 • 007J3 • P • GEN: 4 • 3/15/21 • N

DMR STRATEGY 263C6
SALACOA STRATGY 535F12
R10382064
MS SALACOA PATTON 535A4

HOLLYWOOD OF SALACOA 23A53
MS SALACOA HOLLYWOOD 007G4
R10429919
MS SVF WARRIOR 007Y3

CALVING EASE

- The 007 cow family is a recent generational family that was created by crossing the best of V8 Brahman and Sitz Angus.
- 007J3 is out of a first calf heifer.

ACT BW	ADJ WW	ADJ SC	ADJ REA	ADJ IMF
62	518	38.88	13.43	4.17
HPreg	STAY	TERM	FERT	
6.66	1.15	2.59	0.97	
15%	40%	35%	30%	

CED	BW	WW	YW	MILK	TM	CEM	SC	REA	IMF
5.5	-0.9	22	49	7	65	1.78	1.32	0.48	0.09
35%	15%	55%	45%	65%	65%	95%	5%	20%	50%

74 SALACOA STRATEGY 1893J

GGP AMERICAN CATTLE ENTERPRISE
R10476085 • 1893J • P • GEN: 6 • 4/5/21 • N

TJM CORONADO 535X
DMR STRATEGY 263C6
R10318980
MS CRC CSONKA 263U

AMERICUS OF SALACOA 468Y16
MS SALACOA AMERICUS 1893A
R10248536
MS SVF WARRIOR 1893W

BALANCED EPS WITH MILK

- Sired by calving ease sire DMR Strategy 263C6
- 1893J's 3 maternal brothers have sold in prior sales to average \$6,450.

ACT BW	ADJ WW	ADJ SC	ADJ REA	ADJ IMF
90	613	36.84	13.19	4.33
HPreg	STAY	TERM	FERT	
3.4	1.42	2.7	1.16	
50%	30%	35%	25%	

CED	BW	WW	YW	MILK	TM	CEM	SC	REA	IMF
4.2	0.1	23	48	15	20	1.85	0.86	0.43	0.17
55%	35%	55%	45%	10%	20%	95%	25%	25%	35%

75 SALACOA HOLLYWOOD 209J11

GGP BAD BITCH CATTLE CO
R10476156 • 209J11 • P • GEN: 8 • 3/22/21 • A

NEW VISION OF SALACOA 209Y2
HOLLYWOOD OF SALACOA 23A53
R10251840
MS SVF PATTON 23Y66

DMR SEAL 594C21
CLVR MS SEAL 209E3
R10370776
MS SALACOA CSONKA 209Z15

GROWTH & MUSCLE

- Sired by Brangus patriarch Hollywood 23A53
- 209J11's dam 209E3 has maintained a 368 day calving interval after 3 calves since purchasing her from Clover Ranch.

ACT BW	ADJ WW	ADJ SC	ADJ REA	ADJ IMF
78	663	37.57	13.57	3.54
HPreg	STAY	TERM	FERT	
9.77	1.42	2.78	0.76	
2%	30%	30%	40%	

CED	BW	WW	YW	MILK	TM	CEM	SC	REA	IMF
2.6	0.9	33	65	-3	90	0.61	0.85	0.63	-0.03
75%	60%	25%	20%	>95%	90%	>95%	25%	10%	85%

76 SALACOA EMPIRE 209J19

GGP AMERICAN CATTLE ENTERPRISE
R10475961 • 209J19 • P • GEN: 5 • 4/28/21 • E

TJM THREE D 302A
DMR EMPIRE 795D12
R10323531
MS DMR JETHRO 795Y2

STONEWALL OF RRR 222W6
MS SALACOA STONEWALL 209B6
R10260345
MS BRINKS BRIGHT SIDE 209L11

GROWTH AND MUSCLE

- Out of a super donor cow SVF 209B6
- 209J19's donor dam 209B6 has an average calving interval of 374 days.

ACT BW	ADJ WW	ADJ SC	ADJ REA	ADJ IMF
85 ET	513	36.29	12.37	3.72
HPreg	STAY	TERM	FERT	
9.42	1.36	2.61	0.3	
3%	35%	35%	60%	

CED	BW	WW	YW	MILK	TM	CEM	SC	REA	IMF
2.7	1.5	37	64	2	50	4.21	0.28	0.4	-0.03
70%	75%	15%	20%	95%	50%	25%	75%	30%	85%

BRANGUS BULLS



SALACOA BIG TOWN 332J10

AMERICAN CATTLE ENTERPRISE

R10476119 • 332J10 • P • GEN: 4 • 5/10/21 • N

MC NUFF SAID 889T50

BWCC BIG TOWN 192B16

R10266676

BWCC MS REVELATION 192W8

T3 CORONADO 222C4

MS SALACOA CORONADO 332E16

R10368017

MS SALACOA NEW VISION 332C5

CALVING EASE & MILK

• Big Town x's Coronado assures easy calving.

ACT BW	ADJ WW	ADJ SC	ADJ REA	ADJ IMF
74	541	33.58	11.57	3.45
HPreg	STAY	TERM	FERT	
10.1	0.9	2.1	0.24	
2%	50%	55%	60%	

CED	BW	WW	YW	MILK	TM	CEM	SC	REA	IMF
6.8	-0.4	22	49	10	50	1.91	0.32	0.28	-0.05
25%	25%	55%	45%	35%	50%	95%	75%	45%	90%



SALACOA BRIGHTON 488J8

AMERICAN CATTLE ENTERPRISE

R10476081 • 488J8 • P • GEN: 7 • 3/27/21 • N

LAMBERT OF BRINKS 317R3

BRIGHTON OF SALACOA 392A3

R10237050

MS BRINKS NEW ERA 392P51

KENNESAW OF SALACOA 803Y7

MS SALACOA KENNESAW 488B5

R10259463

SVF UPPERCUT 488 W010

VERY BALANCED EPD'S

• Sired by Carcass King Brighton 392A3
• 488J8's dam 488B5 has an average calving interval of 393 days after 6 calves.

ACT BW	ADJ WW	ADJ SC	ADJ REA	ADJ IMF
82	671	32.48	13.17	5.66
HPreg	STAY	TERM	FERT	
5.7	0.91	3.39	-0.13	
20%	50%	20%	75%	

CED	BW	WW	YW	MILK	TM	CEM	SC	REA	IMF
-0.5	1.4	28	49	6	55	2.5	-0.05	0.47	0.52
95%	70%	35%	45%	75%	55%	80%	95%	20%	5%



SALACOA 535F9 BT 535J18

BAD BITCH CATTLE CO

CAPC

R10476160 • 535J18 • P • GEN: 5 • 4/19/21 • N

BWCC BIG TOWN 192B16

SALACOA BIG TOWN 535F9

R10382058

MS SALACOA STONEWALL 535Z30

WOODSTOCK OF SALACOA 209Z3

GZR MS WOODSTOCK 535D

R10319475

MS DMR GUARDIAN 535B6

CALVING EASE SPECIALIST

• Big Town x Woodstock assures calving ease.

ACT BW	ADJ WW	ADJ SC	ADJ REA	ADJ IMF
50	391	32.92	10.56	3.24
HPreg	STAY	TERM	FERT	
7.31	1.23	0.25	0.89	
10%	40%	>95%	35%	

CED	BW	WW	YW	MILK	TM	CEM	SC	REA	IMF
14.7	-5.1	-8	7	5	>95	4.16	0.17	-0.07	-0.11
1%	1%	>95%	>95%	80%	>95%	30%	85%	95%	>95%



SALACOA 23G75 NV 535J36

AMERICAN CATTLE ENTERPRISE

R10476177 • 535J36 • P • GEN: 7 • 6/1/21 • N

NEW VISION OF SALACOA 209Y2

SALACOA NEW VISION 23G75

R10429949

MS SALACOA PATTON 23Z58

AMERICUS OF SALACOA 468Y16

MS SALACOA AMERICUS 535C19

R10287959

MS SALACOA STONEWALL 535Z34

CALVING EASE

• Stacks the popular Brangus breed sire New Vision 209Y2 multiple times in his pedigree.

ACT BW	ADJ WW	ADJ SC	ADJ REA	ADJ IMF
85	497	37.68	13.42	4.77
HPreg	STAY	TERM	FERT	
5.88	1.28	1.97	1.72	
20%	35%	60%	10%	

CED	BW	WW	YW	MILK	TM	CEM	SC	REA	IMF
5.9	-1.2	14	36	5	90	3.34	0.34	0.5	0.08
30%	15%	85%	75%	80%	90%	55%	70%	15%	50%



SALACOA BIG STONE 392J16

AMERICAN CATTLE ENTERPRISE

R10478854 • 392J16 • P • GEN: 5 • 6/1/21 • N

BWCC BIG TOWN 192B16

SALACOA BIG TOWN 535F9

R10382058

MS SALACOA STONEWALL 535Z30

STONEWALL OF RRR 222W6

MS SALACOA STONEWALL 392E5.

R10345867

MS SALACOA WHITFIELD 392A25

CALVING EASE WITH MILK

• This blend of Big Town and Stonewall will surely guarantee calving ease and should make tremendous moderate, great uddered females.
• 392J16's dam 392E5 has an average calving interval of 387 days after 5 calves.

ACT BW	ADJ WW	ADJ SC	ADJ REA	ADJ IMF
85	487	35.68	11.26	4.03
HPreg	STAY	TERM	FERT	
7.41	1.3	0.94	1.27	
10%	35%	90%	20%	

CED	BW	WW	YW	MILK	TM	CEM	SC	REA	IMF
4.3	-0.4	6	23	12	80	3.53	0.72	0.03	0
50%	25%	>95%	95%	20%	80%	50%	35%	85%	75%



SALACOA BROADWAY 504J

AMERICAN CATTLE ENTERPRISE

R10476022 • 504J • P • GEN: 7 • 3/14/21 • A

HOLLYWOOD OF SALACOA 23A53

T3 BROADWAY 30E

R10367402

MS SALACOA ATLANTA 30B5

HOLLYWOOD OF SALACOA 23A53

MS SALACOA HOLLYWOOD 504E

R10367549

SVF MS 70X2 - 504B

BIRTH TO YEARLING WITH MUSCLE

• Broadway 30E sons are popular in sales for their overall depth and substance.

ACT BW	ADJ WW	ADJ SC	ADJ REA	ADJ IMF
64	625	34.24	14.44	4.23
HPreg	STAY	TERM	FERT	
9.82	1.22	3.59	0.74	
2%	40%	15%	40%	

CED	BW	WW	YW	MILK	TM	CEM	SC	REA	IMF
5.9	-1	36	68	0	60	1.12	0.52	0.73	0.12
30%	15%	20%	15%	>95%	60%	>95%	50%	3%	45%



SALACOA ATLANTA 535J25

AMERICAN CATTLE ENTERPRISE

R10475958 • 535J25 • P • GEN: 5 • 4/25/21 • E

LAMBERT OF BRINKS 317R3

ATLANTA OF SALACOA 488Z

R10210625

MS SVF CADENCE 488X11

TCB CATAWBA WARRIOR R532

MS SVF R532 535X4

R10162656

SVF 820R8 535 U066

BALANCED EPDS WITH HUGE MILK

• Sired by the immortal Atlanta of Salacoa 488Z
• 535J25 is out of one of Salacoa Valley's most famous donors 535X4 who has generated over \$100,000 in progeny.

ACT BW	ADJ WW	ADJ SC	ADJ REA	ADJ IMF
80 ET	569	34.86	12.76	4.17
HPreg	STAY	TERM	FERT	
7.36	1.27	2.96	1.39	
10%	35%	30%	20%	

CED	BW	WW	YW	MILK	TM	CEM	SC	REA	IMF
4.1	0.2	31	51	18	4	0.41	0.67	0.53	0.18
55%	40%	30%	40%	3%	4%	>95%	40%	15%	30%



SALACOA 535F14 STGY 99J13

AMERICAN CATTLE ENTERPRISE

R10476007 • 99J13 • P • GEN: 5 • 3/22/21 • N

DMR STRATEGY 263C6

SALACOA STRATEGY 535F14

R10382066

MS SALACOA PATTON 535A4

NEVER SURRENDER OF SALACOA 803D9

MS SALACOA N SURRENDER 99F32

R10420251

MS SALACOA WHITFIELD 99Z10

MILK & GROWTH

• Calving ease specialist Strategy 263C6 son x a Never Surrender 803D9 daughter packs the best genetics in the Brangus world in one package.
• 99J13's dam 99F32 post a 390 day calving interval after 3 calves.

ACT BW	ADJ WW	ADJ SC	ADJ REA	ADJ IMF
68	540	36.67	13.03	3.42
HPreg	STAY	TERM	FERT	
5.27	1.12	1.95	1.07	
25%	40%	60%	30%	

CED	BW	WW	YW	MILK	TM	CEM	SC	REA	IMF
2.8	1	24	49	10	40	3.62	0.96	0.46	-0.11
70%	60%	50%	45%	35%	40%	45%	20%	20%	>95%

ANGUS DATA KEY

Lot Number → **85**

Registered Name & Owner ← **B3R J504 FIREBALL D531 HR** [M1F]
followed by Genetic Code (if applicable)

Targeting the Brand Designation →  See below for explanation

Additional Information: ←
Date of Birth/Registration Number/
Tattoo

Two Generation Pedigree →

B3R Star Rankings ←
Five stars indicate a bull that will perform with superiority in those identified areas.

Angus EPDs: ←
Growth, Carcass & Maternal EPDs followed by Indexes

Performance Data →

BRADLEY 3 RANCH
Birth Date: 9/7/21 • Bull *20295654 • Tattoo: J504

*GAR SURE FIRE 6404
*GB FIREBALL 672 18690054
*GB ANTICIPATION 432

#*KCF BENNETT ABSOLUTE

HR D531 A261 W299
18876483
HR A261 Y45 X510

Calving Ease	Maternal	Growth	Efficiency	Carcass
★★★★★	★★★★★	★★★★★	★★★★★	★★★★★
DMI	DOC	PAP	HP	
+0.46	+14	-1.24	+12.5	
CW	MARB	RE	FAT	
+42	+1.53	+0.7	+0.029	

• We start with a slick haired Targeting the Brand bull with 5 star calving ease, great gains on both grass and grain and Top 10% \$B and \$C. Here is one to tie to!

CED	BEPD	WEPD	YEPD	SCR	MILK	\$EN
+16	-2	+60	+109	+0.68	+24	-12
\$M	\$F	\$G	\$B	\$C		
+64	+90	+94	+184	+303		
BW	Act. SC	Adj.%IMF	Adj. RibFat	Adj. RmpFat		
60	36.5	4.63	0.19	0.22		

RETAINED INTEREST IN B3R BULLS:

B3R is retaining 1/2 semen interest in all Angus & Charolais B3R bulls selling. The Buyer owns 100% possession and full salvage value. In the event that semen is collected at buyers convenience, B3R will pay for prorated semen collection expenses if B3R choses to participate.



ABOVE AVERAGE GOALS REQUIRE TARGETED BULLS

Aim High

The Targeting the Brand™ logo highlights registered Angus bulls with greater genetic potential to produce calves that meet the most challenging specifications of the *Certified Angus Beef®* brand.

Only 1 in 4 non-parent Angus bulls qualify.

Minimum Genetic Requirements

Marbling EPD (Marb)	+0.65
Dollar Grid Carcass Index (\$G)	+55.0



For more information on Targeting the Brand™ visit CABcattle.com.

Bradley 3 Ranch Angus Bulls

At Bradley 3 Ranch, our goal is to produce predictable genetics for commercial beef producers that wean the most quality pounds from cows exposed to calves weaned. Therefore, we concentrate our breeding efforts on the beef industry's most basic traits while employing the industry's latest technology. Fertility, easy calving, easy fleshing, soundness, high performance, muscle and carcass value. Our experience in the meat business has helped us develop an understanding of the entire food chain, from the cow-calf producer to the consumer at the meat case. These valuable lessons are used in our ranch management decisions every day.



Bradley 3 Ranch, Ltd.

RANCH RAISED. PERFORMANCE SELECTED.

HOME OF THE **WIDE** BODY SALE

65 years of ranch raised, performance selected bulls.

Mary Lou Bradley-Henderson, (940) 585-6471

James Henderson, (940) 585-6171

www.bradley3ranch.com

Stay up to date with us on Facebook: Bradley 3 Ranch 

Bradley 3 Ranch Angus Bulls



“Just going over records and wanted to let you know that since we started getting calves from using your bulls in 2015 our cost per cow has dropped 31.18%, pounds per acre improvement by 36.30% and pounds weaned per cow improvements by 13.21%.”

— CRAIG J. FROM TEXAS



2021 CAB

Sustainability Award



85

B3R J504 FIREBALL D531 HR [M1F]

BRADLEY 3 RANCH

Birth Date: 9/7/21 • Bull *20295654 • Tattoo: J504

+*GAR SURE FIRE 6404

*GB FIREBALL 672

18690054

*GB ANTICIPATION 432

#*KCF BENNETT ABSOLUTE

HR D531 A261 W299

18876483

HR A261 Y45 X510

Calving Ease	Maternal	Growth	Efficiency	Carcass
*****	*****	*****	*****	*****
DMI	DOC	PAP	HP	
+0.46	+14	-1.24	+12.5	
CW	MARB	RE	FAT	
+42	+1.53	+0.7	+0.029	

CED	BEPD	WEPD	YEPD	SCR	MILK	SEN
+16	-2	+60	+109	+0.68	+24	-12
\$M	\$F	\$G	\$B	\$C		
+64	+90	+94	+184	+303		
BW	Act. SC	Adj. %IMF	Adj. RibFat	Adj. RmpFat		
60	36.5	4.63	0.19	0.22		

• We start with a slick haired Targeting the Brand bull with 5 star calving ease, great gains on both grass and grain and Top 10% \$B and \$C. Here is one to tie to!



LOT 85 B3R J504 FIREBALL D531 HR

86

B3R J502 FIREBALL D502 HR

BRADLEY 3 RANCH

Birth Date: 9/9/21 • Bull *20295653 • Tattoo: J502

+*GAR SURE FIRE 6404

*GB FIREBALL 672

18690054

*GB ANTICIPATION 432

#*KCF BENNETT ABSOLUTE

HR D502 A253 W299

18876484

HR A253 Y88 X510

Calving Ease	Maternal	Growth	Efficiency	Carcass
*****	*****	*****	*****	*****
DMI	DOC	PAP	HP	
+1	+21	-1.74	+10.3	
CW	MARB	RE	FAT	
+36	+1	+0.65	-0.008	

CED	BEPD	WEPD	YEPD	SCR	MILK	SEN
+13	+0.1	+60	+108	+0.47	+27	-9
\$M	\$F	\$G	\$B	\$C		
+65	+76	+71	+148	+257		
BW	Act. SC	Adj. %IMF	Adj. RibFat	Adj. RmpFat		
70	36	4.62	0.13	0.19		

• Another Targeting the Brand bull that has 5 star calving ease, great grass gain and can work across tough environments.



LOT 586 B3R J502 FIREBALL D502 HR

87

B3R J507 FIREBALL E601 HR

BRADLEY 3 RANCH

Birth Date: 9/13/21 • Bull *20295633 • Tattoo: J507

*GAR SURE FIRE 6404

*GB FIREBALL 672

18690054

*GB ANTICIPATION 432

#*KCF BENNETT ABSOLUTE

*HR E601 W506 W299

19188734

HR W506 WAVE R187

• Don't miss this one! A slick haired Targeting the Brand bull that is 5 star calving ease, maternal growth, efficiency and carcass. Everything you want in one package.

Calving Ease	Maternal	Growth	Efficiency	Carcass
★★★★★	★★★★★	★★★★★	★★★★★	★★★★★
DMI	DOC	PAP	HP	
+0.34	+22	-2.67	+7.8	
CW	MARB	RE	FAT	
+34	+1.3	+0.79	+0.041	

CED	BEPD	WEPD	YEPD	SCR	MILK	\$EN
+15	-1.5	+55	+94	+0.8	+34	-1
\$M	\$F	\$G	\$B	\$C		
+73	+77	+83	+160	+281		
BW	Act. SC	Adj. %IMF	Adj. RibFat	Adj. RmpFat		
62	36.5	4.7	0.16	0.18		

89

B3R J138 FIREBALL G312

BRADLEY 3 RANCH

Birth Date: 9/4/21 • Bull *20312134 • Tattoo: J138

*GAR SURE FIRE 6404

*GB FIREBALL 672

18690054

*GB ANTICIPATION 432

#B3R CONSENSUS LOOK B040

*B3R G312 BLACKBIRD B040 A296

19692385

#B3R A296 BLACKBIRD U077 R141

• You will like this slick haired Targeting the Brand bull that has the #1 RADG EPD in the offering. 5 stars in all traits, docile, good footed and the #1 \$B and \$C in the offering.

Calving Ease	Maternal	Growth	Efficiency	Carcass
★★★★★	★★★★★	★★★★★	★★★★★	★★★★★
DMI	DOC	PAP	HP	
+0.98	+30	-2.29	+13.9	
CW	MARB	RE	FAT	
+46	+1.32	+0.83	+0.002	

CED	BEPD	WEPD	YEPD	SCR	MILK	\$EN
+18	-1.5	+61	+126	+1.22	+31	-22
\$M	\$F	\$G	\$B	\$C		
+72	+98	+88	+186	+313		
BW	Act. SC	Adj. %IMF	Adj. RibFat	Adj. RmpFat		
61	32.5	4.17	0.18	0.27		

91

B3R J150 FIREBALL G334

BRADLEY 3 RANCH

Birth Date: 9/7/21 • Bull *20312130 • Tattoo: J150

*GAR SURE FIRE 6404

*GB FIREBALL 672

18690054

*GB ANTICIPATION 432

#B3R BASIC PIONEER B121

B3R G334 BLACKBIRD B121 X223

19692286

#B3R X223 BLACKBIRD M070 P317

• If you are breeding heifers, sleep easy with this slick haired Targeting the Brand bull. He will add carcass traits to almost any herd and his Dam weaned 57.16% of her body weight.

Calving Ease	Maternal	Growth	Efficiency	Carcass
★★★★★	★★★★★	★★★★★	★★★★★	★★★★★
DMI	DOC	PAP	HP	
+0.8	+33	-1.95	+11.9	
CW	MARB	RE	FAT	
+34	+1.51	+0.78	+0.031	

CED	BEPD	WEPD	YEPD	SCR	MILK	\$EN
+18	-1.6	+56	+103	+0.99	+26	-5
\$M	\$F	\$G	\$B	\$C		
+77	+75	+94	+169	+296		
BW	Act. SC	Adj. %IMF	Adj. RibFat	Adj. RmpFat		
60	30.5	4.72	0.16	0.2		

93

B3R J509 FIREBALL E615 HR

BRADLEY 3 RANCH

Birth Date: 9/13/21 • Bull *20295639 • Tattoo: J509

*GAR SURE FIRE 6404

*GB FIREBALL 672

18690054

*GB ANTICIPATION 432

#*KCF BENNETT ABSOLUTE

HR E615 Y51 W299

19188726

HR Y51 U277 504

• Take a good look at this slick haired Targeting the Brand bull. He has the #1 WW EPD and #1 YW EPD in the offering. He is Top 10% Marbling, Ribeye and Fat EPD's and Top 10% for \$G, \$B and \$C indexes.

Calving Ease	Maternal	Growth	Efficiency	Carcass
★★★★★	★★★★★	★★★★★	★★★★★	★★★★★
DMI	DOC	PAP	HP	
+0.95	+16	-0.79	+13	
CW	MARB	RE	FAT	
+53	+1.26	+0.99	-0.04	

CED	BEPD	WEPD	YEPD	SCR	MILK	\$EN
+1	+4.3	+77	+134	+1.12	+23	-28
\$M	\$F	\$G	\$B	\$C		
+64	+94	+91	+185	+304		
BW	Act. SC	Adj. %IMF	Adj. RibFat	Adj. RmpFat		
83	40	5.25	0.21	0.18		

88

B3R J517 FIREBALL G816 HR

[M1F]

BRADLEY 3 RANCH

Birth Date: 9/13/21 • Bull *20295489 • Tattoo: J517

*GAR SURE FIRE 6404

*GB FIREBALL 672

18690054

*GB ANTICIPATION 432

HR D19 A203 A477

*HR G816 B335 D19

19171782

HR B335 W531 W458

• This one has the #1 Marbling EPD in the offering (Top 1%) and the #1 Scrotal EPD in the offering (Top 1%). He will add calving ease and carcass to any herd.

Calving Ease	Maternal	Growth	Efficiency	Carcass
★★★★★	★★★★★	★★★★★	★★★★★	★★★★★
DMI	DOC	PAP	HP	
+0.74	+15	-2.56	+9.8	
CW	MARB	RE	FAT	
+31	+1.58	+0.61	+0.017	

CED	BEPD	WEPD	YEPD	SCR	MILK	\$EN
+12	+0	+56	+98	+2.04	+29	-1
\$M	\$F	\$G	\$B	\$C		
+68	+72	+96	+168	+286		
BW	Act. SC	Adj. %IMF	Adj. RibFat	Adj. RmpFat		
56	37	6.19	0.22	0.31		

90

B3R J158 FIREBALL G353

BRADLEY 3 RANCH

Birth Date: 8/29/21 • Bull *20312128 • Tattoo: J158

*GAR SURE FIRE 6404

*GB FIREBALL 672

18690054

*GB ANTICIPATION 432

B3R TENDER POWER D324

*B3R G353 LADY D324 Y210

19693287

B3R Y210 LADY 8212 W236

• If you are going to use Angus on F1 cows, you will like this slick haired Targeting the Brand bull that gained 3.09#/day on grass and 3.81#/day on feed and his Dam weaned 56.64% of her body weight.

Calving Ease	Maternal	Growth	Efficiency	Carcass
★★★★★	★★★★★	★★★★★	★★★★★	★★★★★
DMI	DOC	PAP	HP	
+0.76	+25	-0.99	+2	
CW	MARB	RE	FAT	
+56	+0.99	+0.86	-0.053	

CED	BEPD	WEPD	YEPD	SCR	MILK	\$EN
+7	+0.3	+58	+114	+1.3	+28	-17
\$M	\$F	\$G	\$B	\$C		
+39	+108	+77	+186	+280		
BW	Act. SC	Adj. %IMF	Adj. RibFat	Adj. RmpFat		
64	33	4.56	0.13	0.11		

92

B3R J146 FIREBALL G251

BRADLEY 3 RANCH

Birth Date: 9/9/21 • Bull *20312137 • Tattoo: J146

*GAR SURE FIRE 6404

*GB FIREBALL 672

18690054

*GB ANTICIPATION 432

B3R HILL COUNTRY E412

*B3R G251 NANCY E412 E272

19692199

*B3R E272 NANCY 0035 R039

• A slick haired Targeting the Brand bull that gained 3.14 #/day on grass and 3.11 #/day on feed. Low intake with lots of carcass and a dam that weaned 62.37% of her body weight.

Calving Ease	Maternal	Growth	Efficiency	Carcass
★★★★★	★★★★★	★★★★★	★★★★★	★★★★★
DMI	DOC	PAP	HP	
+0.46	+6	+0.16	+9.6	
CW	MARB	RE	FAT	
+38	+1.55	+0.8	-0.018	

CED	BEPD	WEPD	YEPD	SCR	MILK	\$EN
+7	+1	+61	+102	+0.22	+18	+2
\$M	\$F	\$G	\$B	\$C		
+58	+83	+100	+183	+295		
BW	Act. SC	Adj. %IMF	Adj. RibFat	Adj. RmpFat		
71	32	4	0.11	0.16		



LOT 93 B3R J509 FIREBALL E615 HR

ANGUS BULLS

94

B3R J508 FIREBALL E609 HR

BRADLEY 3 RANCH

Birth Date: 9/12/21 • Bull *20295631 • Tattoo: J508



+*GAR SURE FIRE 6404

*GB FIREBALL 672

18690054

*GB ANTICIPATION 432

#*KCF BENNETT ABSOLUTE

*HR E609 Z163 W299

19296663

HR Z163 R181 W414

Calving Ease	Maternal	Growth	Efficiency	Carcass
★★★★★	★★★★★	★★★★★	★★★★★	★★★★★
DMI	DOC	PAP	HP	
+0.02	+21	-2.9	+10.1	
CW	MARB	RE	FAT	
+12	+1.2	+0.72	+0.01	

CED	BEPD	WEPD	YEPD	SCR	MILK	SEN
+15	-1.9	+44	+76	+0.73	+19	+3
\$M	\$F	\$G	\$B	\$C		
+58	+56	+80	+136	+234		
BW	Act. SC	Adj. %IMF	Adj. RibFat	Adj. RmpFat		
60	36	4.39	0.18	0.18		

Calving Ease	Maternal	Growth	Efficiency	Carcass
★★★★★	★★★★★	★★★★★	★★★★★	★★★★★
DMI	DOC	PAP	HP	
+0.93	+19	+1.85	+10.4	
CW	MARB	RE	FAT	
+44	+1.28	+0.71	+0.018	

CED	BEPD	WEPD	YEPD	SCR	MILK	SEN
+16	-1.9	+59	+112	+1.04	+23	-16
\$M	\$F	\$G	\$B	\$C		
+57	+95	+83	+178	+288		
BW	Act. SC	Adj. %IMF	Adj. RibFat	Adj. RmpFat		
58	38	4.49	0.21	0.23		



LOT 95 B3R J503 FIREBALL D523 HR

95

B3R J503 FIREBALL D523 HR

BRADLEY 3 RANCH

Birth Date: 9/12/21 • Bull *20295656 • Tattoo: J503



+*GAR SURE FIRE 6404

*GB FIREBALL 672

18690054

*GB ANTICIPATION 432

#*KCF BENNETT ABSOLUTE

HR D523 A206 W299

18871395

HR A206 U196 W414

Calving Ease	Maternal	Growth	Efficiency	Carcass
★★★★★	★★★★★	★★★★★	★★★★★	★★★★★
DMI	DOC	PAP	HP	
+0.93	+19	+1.85	+10.4	
CW	MARB	RE	FAT	
+44	+1.28	+0.71	+0.018	

CED	BEPD	WEPD	YEPD	SCR	MILK	SEN
+16	-1.9	+59	+112	+1.04	+23	-16
\$M	\$F	\$G	\$B	\$C		
+57	+95	+83	+178	+288		
BW	Act. SC	Adj. %IMF	Adj. RibFat	Adj. RmpFat		
58	38	4.49	0.21	0.23		

96

B3R J064 FIREBALL G266

BRADLEY 3 RANCH

Birth Date: 8/31/21 • Bull *20312136 • Tattoo: J064



+*GAR SURE FIRE 6404

*GB FIREBALL 672

18690054

*GB ANTICIPATION 432

*B3R ELECTORATE A229

*B3R G266 BLACKBIRD A229 W278

19692214

#*B3R W278 BLACKBIRD R065 R141

Calving Ease	Maternal	Growth	Efficiency	Carcass
★★★★★	★★★★★	★★★★★	★★★★★	★★★★★
DMI	DOC	PAP	HP	
+0.54	+15	-1.79	+7	
CW	MARB	RE	FAT	
+31	+1.3	+0.92	+0.007	

CED	BEPD	WEPD	YEPD	SCR	MILK	SEN
+15	-3.3	+48	+94	+0.35	+26	-14
\$M	\$F	\$G	\$B	\$C		
+37	+79	+88	+167	+254		
BW	Act. SC	Adj. %IMF	Adj. RibFat	Adj. RmpFat		
56	34	5.38	0.24	0.22		

Calving Ease	Maternal	Growth	Efficiency	Carcass
★★★★★	★★★★★	★★★★★	★★★★★	★★★★★
DMI	DOC	PAP	HP	
+0.86	+10	-0.55	+9.3	
CW	MARB	RE	FAT	
+26	+0.69	+0.47	+0.014	

CED	BEPD	WEPD	YEPD	SCR	MILK	SEN
+6	+0.1	+50	+84	-0.39	+25	+6
\$M	\$F	\$G	\$B	\$C		
+66	+57	+53	+110	+209		
BW	Act. SC	Adj. %IMF	Adj. RibFat	Adj. RmpFat		
62	30.5	3.88	0.14	0.17		

97

B3R J501 FIREBALL B304 HR

BRADLEY 3 RANCH

Birth Date: 9/13/21 • Bull *20295665 • Tattoo: J501



+*GAR SURE FIRE 6404

*GB FIREBALL 672

18690054

GB ANTICIPATION 432

*B3R PIONEER WAVE Y409

HR B304 X10 PIONEER WAVE

18269641

#HR X10 T307 U103

Calving Ease	Maternal	Growth	Efficiency	Carcass
★★★★★	★★★★★	★★★★★	★★★★★	★★★★★
DMI	DOC	PAP	HP	
+0.42	+22	-0.85	+11.5	
CW	MARB	RE	FAT	
+43	+1.35	+0.73	+0.017	

CED	BEPD	WEPD	YEPD	SCR	MILK	SEN
+7	+1.2	+63	+106	-0.01	+24	-4
\$M	\$F	\$G	\$B	\$C		
+73	+91	+87	+178	+304		
BW	Act. SC	Adj. %IMF	Adj. RibFat	Adj. RmpFat		
80	37	4.99	0.23	0.28		

Calving Ease	Maternal	Growth	Efficiency	Carcass
★★★★★	★★★★★	★★★★★	★★★★★	★★★★★
DMI	DOC	PAP	HP	
-0.02	+27	+0.72	+14.3	
CW	MARB	RE	FAT	
+36	+0.83	+0.93	-0.01	

CED	BEPD	WEPD	YEPD	SCR	MILK	SEN
+0	+0.6	+45	+79	+0.81	+16	+1
\$M	\$F	\$G	\$B	\$C		
+61	+85	+67	+153	+259		
BW	Act. SC	Adj. %IMF	Adj. RibFat	Adj. RmpFat		
75	32.5	4.08	0.12	0.1		

98

B3R J154 ELECTORATE G383

BRADLEY 3 RANCH

Birth Date: 8/30/21 • Bull *20309013 • Tattoo: J154



B3R PRIME WAVE T299

*B3R ELECTORATE A229

17779610

B3R X202 LADY U149 T053

B3R TENDER PRODUCT C278

*B3R G383 CARLA C278 A209

19692450

B3R A209 CARLA W446 X266

• A slick haired bull with lots of growth. He gained 4.85#/day on grass (#1 in the offering) 3.26#/day on feed and his dam Weaned 56.94% of her body weight. He is good footed with Top 10% \$EN.

Calving Ease	Maternal	Growth	Efficiency	Carcass
★★★★★	★★★★★	★★★★★	★★★★★	★★★★★
DMI	DOC	PAP	HP	
+0.86	+10	-0.55	+9.3	
CW	MARB	RE	FAT	
+26	+0.69	+0.47	+0.014	

CED	BEPD	WEPD	YEPD	SCR	MILK	SEN
+6	+0.1	+50	+84	-0.39	+25	+6
\$M	\$F	\$G	\$B	\$C		
+66	+57	+53	+110	+209		
BW	Act. SC	Adj. %IMF	Adj. RibFat	Adj. RmpFat		
62	30.5	3.88	0.14	0.17		

99

B3R J132 BUCHANAN G234

BRADLEY 3 RANCH

Birth Date: 9/15/21 • Bull *20309008 • Tattoo: J132



*B3R ELECTORATE A229

*B3R BUCHANAN G298

19692371

#B3R C334 CARMEN W242 T276

*B3R BASIC PIONEER B121

*B3R G234 ELISE B121 E111

19692183

B3R E111 ELISE Z422 W072

• A slick haired Targeting the Brand bull that is Top 25% heifer Pregency EPD, Top 25% Docility EPD, Top 10% Dry Matter intake EPD and Top 25% \$EN.

Calving Ease	Maternal	Growth	Efficiency	Carcass
★★★★★	★★★★★	★★★★★	★★★★★	★★★★★
DMI	DOC	PAP	HP	
-0.02	+27	+0.72	+14.3	
CW	MARB	RE	FAT	
+36	+0.83	+0.93	-0.01	

CED	BEPD	WEPD	YEPD	SCR	MILK	SEN
+0	+0.6	+45	+79	+0.81	+16	+1
\$M	\$F	\$G	\$B	\$C		
+61	+85	+67	+153	+259		
BW	Act. SC	Adj. %IMF	Adj. RibFat	Adj. RmpFat		
75	32.5	4.08	0.12	0.1		

100 B3R J278 FNAL DIRECTION D093

BRADLEY 3 RANCH

Birth Date: 9/12/21 • Bull *20309070 • Tattoo: J278

#*SAV FINAL ANSWER 0035

• A slick haired heifer bull that is efficient and gained 3.26#/day on feed.

+*B3R FINAL DIRECTION F307

19390565

#*B3R R039 BLACKBRD M048 N123

#*SAV FINAL ANSWER 0035

+*B3R D093 NANCY 0035 R039

18753319

#*B3R R039 BLACKBRD M048 N123

Calving Ease	Maternal	Growth	Efficiency	Carcass
★★★★★	★★★★★	★★★★★	★★★★★	★★★★★
DMI	DOC	PAP	HP	
+0.18	+18	-0.75	+10.7	
CW	MARB	RE	FAT	
+33	+0.24	+0.34	-0.001	

CED	BEPD	WEPD	YEPD	SCR	MILK	SEN
+9	-1.2	+62	+95	+0.96	+9	-8
\$M	\$F	\$G	\$B	\$C		
+43	+74	+31	+105	+179		
BW	Act. SC	Adj. %IMF	Adj. RibFat	Adj. RmpFat		
74	37	4.09	0.13	0.13		



LOT 100 B3R J278 FNAL DIRECTION D093

101 B3R J103 CAPROCK F107

BRADLEY 3 RANCH

Birth Date: 9/2/21 • Bull *20309070 • Tattoo: J103

*CONNEALY CONCORD

• A Slick haired Targeting the Brand bull that will work on a heifer and gained 3.62#/day on feed. Heifer is good footed and has a big scrotal.

+*B3R CAPROCK F358

19394203

#*B3R D229 CHESS W299

+*B3R G... SE... 19

19692060

#*B3R... SE... 19

Calving Ease	Maternal	Growth	Efficiency	Carcass
★★★★★	★★★★★	★★★★★	★★★★★	★★★★★
DMI	DOC	PAP	HP	
+15	-0.06	+11.8		
CW	MARB	RE	FAT	
+1.03	+0.74	+0.007		

CED	BEPD	WEPD	YEPD	SCR	MILK	SEN
+13	+72	+1.41	+30	-1		
\$M	\$F	\$G	\$B	\$C		
+68	+73	+125	+230			
BW	Act. SC	Adj. %IMF	Adj. RibFat	Adj. RmpFat		
47	35	4.67	0.2	0.24		

103 B3R J556 F571 A238 HR

BRADLEY 3 RANCH

Birth Date: 9/11/21 • Bull 20294264 • Tattoo: J556

*CONNEALY CONCORD

• A good footed bull that is efficient calving ease and gained 3.24#/day on feed.

+*HR F571 D572 427E

19381896

*HR D572 Z116 X539

B34 W414 WAVE A272 R242 HR

HR A238 R181 W414

17863866

B3R R181 THYMAC 0140 7186

Calving Ease	Maternal	Growth	Efficiency	Carcass
★★★★★	★★★★★	★★★★★	★★★★★	★★★★★
DMI	DOC	PAP	HP	
+0.27	+20	+1.58	+13.8	
CW	MARB	RE	FAT	
+25	+0.61	+0.7	-0.001	

CED	BEPD	WEPD	YEPD	SCR	MILK	SEN
+7	+0.4	+42	+67	+0.31	+22	+0
\$M	\$F	\$G	\$B	\$C		
+66	+62	+53	+116	+216		
BW	Act. SC	Adj. %IMF	Adj. RibFat	Adj. RmpFat		
61	36	3.91	0.2	0.3		

105 B3R J145 PATRIARCH G206

BRADLEY 3 RANCH

Birth Date: 9/8/21 • Bull *20312124 • Tattoo: J145

#*SS NIAGARA Z29

• This is a good footed highly efficient heifer-bull that gained 3.10#/day on grass and 3.93#/day on feed.

+*TEHAMA PATRIARCH F028

18981191

TEHAMA ELITE BLACKBIRD D826

*B3R FINAL WAVE D449

+*B3R G206 LADY D449 E146

19692156

*B3R E146 LADY Z180 B280

Calving Ease	Maternal	Growth	Efficiency	Carcass
★★★★★	★★★★★	★★★★★	★★★★★	★★★★★
DMI	DOC	PAP	HP	
+1.29	+4	+0.43	+14.1	
CW	MARB	RE	FAT	
+32	+0.63	+0.73	+0.007	

CED	BEPD	WEPD	YEPD	SCR	MILK	SEN
+10	-1.9	+46	+85	+0.41	+27	+4
\$M	\$F	\$G	\$B	\$C		
+68	+73	+54	+126	+231		
BW	Act. SC	Adj. %IMF	Adj. RibFat	Adj. RmpFat		
51	30.5	4.05	0.21	0.23		

102 B3R J557 F571 A239 HR

BRADLEY 3 RANCH

Birth Date: 9/9/21 • Bull 20294265 • Tattoo: J557

*CONNEALY CONCORD

• You will like this big growthy bull that gained 3.50#/day on feed has a Top 25% Ribeye EPD and is Top 10% fat.

+*HR F571 D572 427E

19381896

*HR D572 Z116 X539

HP LAD 504

HR A239 W530 504

17863878

HR W530 PRIMESTAR T283

Calving Ease	Maternal	Growth	Efficiency	Carcass
★★★★★	★★★★★	★★★★★	★★★★★	★★★★★
DMI	DOC	PAP	HP	
+0.9	+22	+2.04	+13.5	
CW	MARB	RE	FAT	
+49	+0.36	+0.89	-0.023	

CED	BEPD	WEPD	YEPD	SCR	MILK	SEN
+0	+2.8	+66	+112	+0.67	+16	-15
\$M	\$F	\$G	\$B	\$C		
+57	+95	+46	+141	+240		
BW	Act. SC	Adj. %IMF	Adj. RibFat	Adj. RmpFat		
90	38	3.83	0.14	0.2		

104 B3R J119 PATRIARCH G127

BRADLEY 3 RANCH

Birth Date: 9/9/21 • Bull *20312133 • Tattoo: J119

#*SS NIAGARA Z29

• Don't miss this one! He is five stars across the board. You can use him for most anything you would want. If you like numbers, you will like him.

+*TEHAMA PATRIARCH F028

18981191

TEHAMA ELITE BLACKBIRD D826

B3R TENDER SWING B141

B3R G127 CARMEN B141 X198

19692079

B3R X198 CARMEN T299 T112

Calving Ease	Maternal	Growth	Efficiency	Carcass
★★★★★	★★★★★	★★★★★	★★★★★	★★★★★
DMI	DOC	PAP	HP	
+2.1	+22	-1.77	+13.3	
CW	MARB	RE	FAT	
+54	+0.69	+0.94	+0.002	

CED	BEPD	WEPD	YEPD	SCR	MILK	SEN
+9	+0	+70	+131	+1.32	+29	-19
\$M	\$F	\$G	\$B	\$C		
+73	+93	+60	+153	+271		
BW	Act. SC	Adj. %IMF	Adj. RibFat	Adj. RmpFat		
65	31	4.15	0.18	0.2		

106 B3R J142 PATRIARCH G212

BRADLEY 3 RANCH

Birth Date: 9/9/21 • Bull *20312121 • Tattoo: J142

#*SS NIAGARA Z29

• A gentle Targeting the Brand, good footed bull that is highly efficient and gained 3.69#/day on feed.

+*TEHAMA PATRIARCH F028

18981191

TEHAMA ELITE BLACKBIRD D826

*B3R FINAL WAVE D449

+*B3R G212 ERICA D449 E067

19692161

*B3R E067 ERICA W494 C111

Calving Ease	Maternal	Growth	Efficiency	Carcass
★★★★★	★★★★★	★★★★★	★★★★★	★★★★★
DMI	DOC	PAP	HP	
+0.96	+32	+0.27	+10	
CW	MARB	RE	FAT	
+41	+0.78	+0.72	+0.026	

CED	BEPD	WEPD	YEPD	SCR	MILK	SEN
+12	-0.3	+49	+105	-0.1	+26	-15
\$M	\$F	\$G	\$B	\$C		
+59	+95	+59	+154	+259		
BW	Act. SC	Adj. %IMF	Adj. RibFat	Adj. RmpFat		
70	30.5	4.39	0.13	0.13		

ANGUS BULLS

107

B3R J135 SABINE G430

BRADLEY 3 RANCH

Birth Date: 9/15/21 • Bull *20309009 • Tattoo: J135

*B3R BASIC PIONEER B121

*B3R SABINE G274

19692222

B3R X202 LADY U149 T053

*B3R CONSENSUS LOOK B040

B3R G430 BLACKCAP B040 X309

19692492

B3R X309 BLACKCAP P088 R017

CED	BEPD	WEPD	YEPD	SCR	MILK	SEN
+8	+0.6	+46	+78	+0.67	+20	+13
\$M	\$F	\$G	\$B	\$C		
+76	+63	+39	+102	+208		
BW	Act. SC	Adj. %IMF	Adj. RibFat	Adj. RmpFat		
68	29.5	4.55	0.13	0.14		

Calving Ease	Maternal	Growth	Efficiency	Carcass
★★★★★	★★★★★	★★★★★	★★★★★	★★★★★
DMI	DOC	PAP	HP	
-0.04	+32	+1.24	+9	
CW	MARB	RE	FAT	
+23	+0.43	+0.31	+0.008	

• A slick haired good footed bull that is gentle, highly efficient gained 3.25#/day on feed and his dam weigned 56.07% of her body weight.

108

B3R J551 F520 E612 HR

BRADLEY 3 RANCH

Birth Date: 9/15/21 • Bull *20294259 • Tattoo: J551

*CONNEALY CONCORD

*HR F520 B298 427E

19381939

*HR B298 Y89 REAL MONEY

*B3R B438 PIONR WVE X41 HR

*HR E612 B319 B438

19161771

HR B319 U155 PALO DURO

CED	BEPD	WEPD	YEPD	SCR	MILK	SEN
-2	+3.7	+64	+111	+0.52	+23	-18
\$M	\$F	\$G	\$B	\$C		
+72	+112	+48	+160	+280		
BW	Act. SC	Adj. %IMF	Adj. RibFat	Adj. RmpFat		
80	35	4.79	0.2	0.21		

Calving Ease	Maternal	Growth	Efficiency	Carcass
★★★★★	★★★★★	★★★★★	★★★★★	★★★★★
DMI	DOC	PAP	HP	
+1.03	+20	+1.99	+16.6	
CW	MARB	RE	FAT	
+62	+0.45	+1.01	+0.018	

• This is a great bull to use on mature cows. Number one in the offering for Heifer Pregnancy, Carcass Weight, Ribeye and \$F. He is slick haired good footed and gained 3.32#/day on feed.

109

B3R J220 CONSENSUS LOOK F114

BRADLEY 3 RANCH

Birth Date: 8/9/21 • Bull *20309037 • Tattoo: J220

#CONNEALY CONSENSUS 7229

*B3R CONSENSUS LOOK B040

18104943

*MCKELLAR BLINNA PEARL 2421

B3R REAL MONEY X523

B3R F114 BLACKCAP X523 2069

19390417

PAR TRIPLE J BLACKCAP 2069

CED	BEPD	WEPD	YEPD	SCR	MILK	SEN
+12	+0.9	+48	+87	+1.17	+26	+10
\$M	\$F	\$G	\$B	\$C		
+69	+74	+55	+129	+236		
BW	Act. SC	Adj. %IMF	Adj. RibFat	Adj. RmpFat		
104	36.5	3.94	0.15	0.15		

Calving Ease	Maternal	Growth	Efficiency	Carcass
★★★★★	★★★★★	★★★★★	★★★★★	★★★★★
DMI	DOC	PAP	HP	
+0.14	+22	+0.34	+10	
CW	MARB	RE	FAT	
+24	+0.79	+0.43	+0.031	

• Take a good look at this slick haired Targeting the Brand bull that is highly efficient and gained 3.14#/day on grass and 4.24#/day on feed.



LOT 109 B3R J220 CONSENSUS LOOK F114

110

B3R J166 CONSENSUS LOOK G208

BRADLEY 3 RANCH

Birth Date: 9/15/21 • Bull *20309014 • Tattoo: J166

#CONNEALY CONSENSUS 7229

*B3R CONSENSUS LOOK B040

18104943

*MCKELLAR BLINNA PEARL 2421

B3R HILL COUNTRY E412

*B3R G208 CARLA E412 E112

19692158

*B3R E112 CARLA A229 A156

CED	BEPD	WEPD	YEPD	SCR	MILK	SEN
+9	+1	+56	+109	+1.74	+30	-14
\$M	\$F	\$G	\$B	\$C		
+57	+83	+47	+130	+226		
BW	Act. SC	Adj. %IMF	Adj. RibFat	Adj. RmpFat		
78	35	4.26	0.17	0.24		

Calving Ease	Maternal	Growth	Efficiency	Carcass
★★★★★	★★★★★	★★★★★	★★★★★	★★★★★
DMI	DOC	PAP	HP	
+1.03	+20	-0.02	+10.5	
CW	MARB	RE	FAT	
+41	+0.59	+0.45	+0.019	

• A Slick haired good footed, big scrotal bull that gained 3.35#/day on feed that will work at any elevation.

111

B3R J109 CONSENSUS LOOK G262

BRADLEY 3 RANCH

Birth Date: 9/12/21 • Bull *20308999 • Tattoo: J109

#CONNEALY CONSENSUS 7229

*B3R CONSENSUS LOOK B040

18104943

*MCKELLAR BLINNA PEARL 2421

B3R PIONEER LADD C429

*B3R G262 BLACKBIRD C429 Z310

19692210

*B3R Z310 BLACKBIRD U019 R264

CED	BEPD	WEPD	YEPD	SCR	MILK	SEN
+8	-0.1	+50	+96	+0.91	+25	-19
\$M	\$F	\$G	\$B	\$C		
+53	+90	+63	+154	+253		
BW	Act. SC	Adj. %IMF	Adj. RibFat	Adj. RmpFat		
76	34	4.45	0.21	0.28		

Calving Ease	Maternal	Growth	Efficiency	Carcass
★★★★★	★★★★★	★★★★★	★★★★★	★★★★★
DMI	DOC	PAP	HP	
+0.61	+19	+1.53	+12.1	
CW	MARB	RE	FAT	
+42	+0.92	+0.5	+0.019	

• This slick haired Targeting the Brand bull is out of a first calf heifer that weaned 62.23% fo her body weight. He has the #1 foot EPD's in the offering and gained 3.86#/day on grass and 3.69#/day on Feed.

112

B3R J131 HILL COUNTRY G246

BRADLEY 3 RANCH

Birth Date: 8/26/21 • Bull *20309007 • Tattoo: J131

#KCF BENNETT ABSOLUTE

B3R HILL COUNTRY E412

19076077

HR A251 Y80 X510

*B3R ABSOLUTE WAVE D484

B3R G246 CARMEN D484 E233

19692194

*B3R E233 CARMEN Y409 C207

CED	BEPD	WEPD	YEPD	SCR	MILK	SEN
+5	+1	+60	+98	+0.98	+16	-3
\$M	\$F	\$G	\$B	\$C		
+60	+81	+50	+131	+230		
BW	Act. SC	Adj. %IMF	Adj. RibFat	Adj. RmpFat		
70	33.5	4.13	0.11	0.13		

Calving Ease	Maternal	Growth	Efficiency	Carcass
★★★★★	★★★★★	★★★★★	★★★★★	★★★★★
DMI	DOC	PAP	HP	
+0.04	+18	-1.63	+10.1	
CW	MARB	RE	FAT	
+38	+0.66	+0.45	+0.028	

• Slick haired, good footed, highly efficient bull that gained 3.17#/day on grass and 3.29#/day on feed and will work at any elevation.

113

B3R J112 HILL COUNTRY G433

BRADLEY 3 RANCH

Birth Date: 9/9/21 • Bull *20309002 • Tattoo: J112

#KCF BENNETT ABSOLUTE

B3R HILL COUNTRY E412

19076077

HR A251 Y80 X510

*B3R B123 RITO S192 Z148

B3R G433 KEP MISS B123 U253

19692495

B3R U253 KEP MISS N134 N097

CED	BEPD	WEPD	YEPD	SCR	MILK	SEN
+4	+2.1	+47	+89	+0.59	+11	-10
\$M	\$F	\$G	\$B	\$C		
+43	+81	+53	+134	+217		
BW	Act. SC	Adj. %IMF	Adj. RibFat	Adj. RmpFat		
76	31.5	4.42	0.12	0.13		

Calving Ease	Maternal	Growth	Efficiency	Carcass
★★★★★	★★★★★	★★★★★	★★★★★	★★★★★
DMI	DOC	PAP	HP	
+0.7	+25	-1.9	+12.4	
CW	MARB	RE	FAT	
+33	+0.52	+0.84	-0.028	

• Slick Haired Good Footed bull that gained 3.18#/day on grass and 4.33#/day on feed. He is Docile with a Top 25% Ribeye EPD and will work at any elevation.

114 B3R J226 FINAL ANSWER F251

BRADLEY 3 RANCH

Birth Date: 9/16/21 • Bull *20309040 • Tattoo: J226

+*YON FINAL ANSWER W494

*B3R FINAL ANSWER E196
19090310

#B3R C382 ERICA Z053 W037

B3R Z151 RITO 3TDD X325

*B3R F251 BLACKBIRD Z151 C225

19390513
*B3R C225 BLACKBIRD Z187 Z232

CED	BEPD	WEPD	YEPD	SCR	MILK	SEN
+14	-1.6	+45	+90	+0.63	+23	-23
\$M	\$F	\$G	\$B	\$C		
+45	+70	+51	+121	+202		
BW	Act. SC	Adj. %IMF	Adj. RibFat	Adj. RmpFat		
46	34	5.04	0.23	0.28		

Calving Ease	Maternal	Growth	Efficiency	Carcass
*****	*****	*****	*****	*****
DMI	DOC	PAP	HP	
+0.76	+35	+2.1	+13.9	
CW	MARB	RE	FAT	
+28	+0.57	+0.79	+0.021	

Calving Ease	Maternal	Growth	Efficiency	Carcass
*****	*****	*****	*****	*****
DMI	DOC	PAP	HP	
+0.76	+35	+2.1	+13.9	
CW	MARB	RE	FAT	
+28	+0.57	+0.79	+0.021	

116 B3R J540 F505 E641 HR

BRADLEY 3 RANCH

Birth Date: 9/11/21 • Bull *20294248 • Tattoo: J540

*CONNELLY CONCORD

B3R F505 CONCORD A233 HR
19387550

HR A233 U418 PIONEER

*B3R PIONEER WAVE Y409

*HR E641 Y81 Y409

19188772
HR Y81 S074 M070

CED	BEPD	WEPD	YEPD	SCR	MILK	SEN
+5	+1.6	+57	+107	+0.37	+16	-13
\$M	\$F	\$G	\$B	\$C		
+53	+86	+47	+133	+226		
BW	Act. SC	Adj. %IMF	Adj. RibFat	Adj. RmpFat		
83	36	4.31	0.22	0.25		

Calving Ease	Maternal	Growth	Efficiency	Carcass
*****	*****	*****	*****	*****
DMI	DOC	PAP	HP	
+0.83	+20	+1.1	+13.2	
CW	MARB	RE	FAT	
+36	+0.53	+0.63	+0.012	

Calving Ease	Maternal	Growth	Efficiency	Carcass
*****	*****	*****	*****	*****
DMI	DOC	PAP	HP	
+0.83	+20	+1.1	+13.2	
CW	MARB	RE	FAT	
+36	+0.53	+0.63	+0.012	

117 B3R J571 G688 G806 HR

BRADLEY 3 RANCH

Birth Date: 9/11/21 • Bull *20294279 • Tattoo: J571

#*KCF BENNETT ABSOLUTE

*B3R G688 ABSOLUTE Z173 HR
19674125

HR Z173 R195 W414

*B3R ELECTORATE A229

HR G806 A243 A229

19711772
HR A243 W508 504

CED	BEPD	WEPD	YEPD	SCR	MILK	SEN
+8	+0.4	+47	+87	+0.36	+32	-4
\$M	\$F	\$G	\$B	\$C		
+55	+67	+81	+148	+247		
BW	Act. SC	Adj. %IMF	Adj. RibFat	Adj. RmpFat		
77	36	4.58	0.18	0.29		

Calving Ease	Maternal	Growth	Efficiency	Carcass
*****	*****	*****	*****	*****
DMI	DOC	PAP	HP	
+0.2	+11	+0.44	+10.4	
CW	MARB	RE	FAT	
+27	+1.24	+0.73	+0.02	

Calving Ease	Maternal	Growth	Efficiency	Carcass
*****	*****	*****	*****	*****
DMI	DOC	PAP	HP	
+0.2	+11	+0.44	+10.4	
CW	MARB	RE	FAT	
+27	+1.24	+0.73	+0.02	

118 B3R J574 G688 G828 HR

BRADLEY 3 RANCH

Birth Date: 9/15/21 • Bull *20294282 • Tattoo: J574

#*KCF BENNETT ABSOLUTE

*B3R G688 ABSOLUTE Z173 HR
19674125

HR Z173 R195 W414

B3R C418 BANDO Z476 R066 HR

*HR G828 D528 C418

19711792
*HR D528 X37 Y409

CED	BEPD	WEPD	YEPD	SCR	MILK	SEN
+4	+2.9	+48	+78	+1.32	+19	+2
\$M	\$F	\$G	\$B	\$C		
+53	+66	+50	+116	+203		
BW	Act. SC	Adj. %IMF	Adj. RibFat	Adj. RmpFat		
72	39.5	4.37	0.22	0.25		

Calving Ease	Maternal	Growth	Efficiency	Carcass
*****	*****	*****	*****	*****
DMI	DOC	PAP	HP	
-0.19	+10	-2.15	+11.7	
CW	MARB	RE	FAT	
+24	+0.61	+0.68	+0.029	

Calving Ease	Maternal	Growth	Efficiency	Carcass
*****	*****	*****	*****	*****
DMI	DOC	PAP	HP	
-0.19	+10	-2.15	+11.7	
CW	MARB	RE	FAT	
+24	+0.61	+0.68	+0.029	

115 B3R J536 F505 D528 HR

BRADLEY 3 RANCH

Birth Date: 9/14/21 • Bull *20294244 • Tattoo: J536



*CONNELLY CONCORD

B3R F505 CONCORD A233 HR
19387550

HR A233 U418 PIONEER

*B3R PIONEER WAVE Y409

*HR D528 X37 Y409

18871418
HR X37 504 S225

CED	BEPD	WEPD	YEPD	SCR	MILK	SEN
+10	+0.1	+43	+77	-0.15	+17	+8
\$M	\$F	\$G	\$B	\$C		
+64	+93	+61	+154	+264		
BW	Act. SC	Adj. %IMF	Adj. RibFat	Adj. RmpFat		
75	34.5	4.33	0.16	0.24		

Calving Ease	Maternal	Growth	Efficiency	Carcass
*****	*****	*****	*****	*****
DMI	DOC	PAP	HP	
+0.25	+11	-1.94	+11.9	
CW	MARB	RE	FAT	
+40	+0.71	+0.98	+0.011	

Calving Ease	Maternal	Growth	Efficiency	Carcass
*****	*****	*****	*****	*****
DMI	DOC	PAP	HP	
+0.25	+11	-1.94	+11.9	
CW	MARB	RE	FAT	
+40	+0.71	+0.98	+0.011	



LOT 117 B3R J571 G688 G806 HR

119 B3R J521 D403 D572 HR

BRADLEY 3 RANCH

Birth Date: 9/11/21 • Bull *20294229 • Tattoo: J521

#*KCF BENNETT ABSOLUTE

B3R D403 RITO ABSOLUTE A244HR
18778889

#HR A244 T012 PIONEER

*B3R X539 BANDO CB T423 HR

*HR D572 Z116 X539

18871457
HR Z116 R168 W458

CED	BEPD	WEPD	YEPD	SCR	MILK	SEN
+1	+2.4	+66	+103	+1.47	+16	-9
\$M	\$F	\$G	\$B	\$C		
+63	+90	+51	+142	+247		
BW	Act. SC	Adj. %IMF	Adj. RibFat	Adj. RmpFat		
70	41.5	4.31	0.2	0.2		

Calving Ease	Maternal	Growth	Efficiency	Carcass
*****	*****	*****	*****	*****
DMI	DOC	PAP	HP	
+0.65	+19	-0.85	+13.9	
CW	MARB	RE	FAT	
+54	+0.6	+0.88	+0.044	

Calving Ease	Maternal	Growth	Efficiency	Carcass
*****	*****	*****	*****	*****
DMI	DOC	PAP	HP	
+0.65	+19	-0.85	+13.9	
CW	MARB	RE	FAT	
+54	+0.6	+0.88	+0.044	

Charolais Bull Offering



The Bradley 3 Ranch Charolais herd is evolving to be a breed leader for performance driven, powerful Charolais bulls with marbling and muscle. This year's offering is IMPRESSIVE! We have incorporated genetics from the M6, Camp Cooley and Lindskov-Theil herds and made the bulls live up to the Bradley 3 Ranch standards!

All bulls have birth weight recorded, have been ultra-sounded, DNA genomically tested for enhanced EPDs and parent verification. All of these bulls have been through our program of grass gain test this past May-August.





LOT 120 B3R HOME GROWN J638

120

B3R HOME GROWN J638

BRADLEY 3 RANCH

Birth Date: 8/26/21 • Bull M969120 • Tattoo: J638 • P



M6 COOL REP 8108 ET

M6 HOME GROWN 787

M891385

ROR AGATHA 087

M6 NEW STANDARD 842 P ET

PC MS NEW STANDARD 722

F1257675

PC MS COOL REP 357

• What a way to start with the Top WW EPD bull that is in the Top 1% of the breed with Top 10% Carcass EPD's. He gained 3.62#/day on grass and 4.31#/day on feed, is Top 10% EPD's for Scrotal and Maternal and a Top 25% TSI.

REA	MARB	TSI
0.66	0.19	274.97
Calving Ease	Maternal	Growth
★★★★	★★★★	★★★★

CED	BEPD	WEPD	YEPD	SCR	MILK	MCE	MTNL
0.2	2.3	71	134	0.9	26	0.13	62
BW	Adj. YW	Act. SC	Act.%IMF	IMF Ratio	Act. REA	Act. RibFat	
92	1315	39	4.3	125	12.94	0.18	

121

B3R HOME GROWN J642

BRADLEY 3 RANCH

Birth Date: 9/17/21 • Bull M969121 • Tattoo: J642 • P



M6 COOL REP 8108 ET

M6 HOME GROWN 787

M891385

ROR AGATHA 087

M6 COOL REP 8108 ET

PC MS COOL REP 731

F1257686

PC MS FERNANDO 954

• Another like the first bull. Top 10% WW and YW EPD's that gained 3.93#/day on grass and 3.26#/day on feed. He has Top 25% TSI and Top 10% Maternal.

REA	MARB	TSI
0.85	0.10	261.05
Calving Ease	Maternal	Growth
★★★★	★★★★	★★★★

CED	BEPD	WEPD	YEPD	SCR	MILK	MCE	MTNL
2.5	2.8	73	124	1.0	28	0.12	64
BW	Adj. YW	Act. SC	Act.%IMF	IMF Ratio	Act. REA	Act. RibFat	
91	1209	39	3.64	107	12.44	0.11	

122

B3R PINNACLE J661

BRADLEY 3 RANCH

Birth Date: 8/20/21 • Bull M969068 • Tattoo: J661 • P



M6 NEW STANDARD 842 P ET

M6 PINNACLE 712 PLD ET

EM899728

M6 COOL GERMAINE 1145 P ET

M6 NEW PROMISE 103 P

ROR PROMISE 4139

F1190244

LS MS 927 TANYA 7612 PLD

• Polled calving ease bull with Top 10% WW EPD and Top 25% YW EPD that gained 3.48#/day on grass. He is Top 25% Marbling and Top 10% Ribeye with the number 1 milk EPD in the offspring and Top 10% TSI.

REA	MARB	TSI
1.01	0.23	271.05
Calving Ease	Maternal	Growth
★★★★	★★★★	★★★★

CED	BEPD	WEPD	YEPD	SCR	MILK	MCE	MTNL
12.3	-1.4	76	129	1.3	32	0.13	69
BW	Adj. YW	Act. SC	Act.%IMF	IMF Ratio	Act. REA	Act. RibFat	
70	1021	39	3.77	105	12.43	0.14	

CHAROLAIS BULLS



LOT 123 & 124 SIRE M6 PINNACLE 712 PLD ET

123



B3R PINNACLE J673

BRADLEY 3 RANCH

Birth Date: 8/26/21 • Bull M967770 • Tattoo: J673 • P

M6 NEW STANDARD 842 P ET

M6 PINNACLE 712 PLD ET

EM899728

M6 COOL GERMAINE 1145 P ET

M6 COOL REP 8108 ET

ROR COOL LADY 512

F1197416

ROR WIND 908

• No dehorning worries with this homozygous polled bull with Top 25% WW and YW EPD's that gained 3.59#/day on grass and 3.43#/day on feed. Top 10% Ribeye and scrotal EPD's with Top 25% Milk and Maternal.

REA	MARB	TSI					
0.89	0.01	255.37					
Calving Ease	Maternal	Growth	Carcass				
★★★★	★★★★	★★★★	★★★★				
CED	BEPD	WEPD	YEPD	SCR	MILK	MCE	MTNL
7.3	-0.3	70	118	0.9	26	0.14	61
BW	Adj. YW	Act. SC	Act. %IMF	IMF Ratio	Act. REA	Act. RibFat	
75	1062	35	3.63	99	12.68	0.21	

124



B3R PINNACLE J674

BRADLEY 3 RANCH

Birth Date: 8/26/21 • Bull M967769 • Tattoo: J674 • P

M6 NEW STANDARD 842 P ET

M6 PINNACLE 712 PLD ET

EM899728

M6 COOL GERMAINE 1145 P ET

M6 COOL REP 8108 ET

ROR COOL GRADE 5105

F1201790

LS COOL LADY 9302

• Polled big growth bull with the #3 TSI in the offering. He is Top 10% WW and YE EPD's that gained 3.58#/grass and 4.00#/day on feed. He is Top 10% EPD's for Ribeye, Scrotal and Maternal.

REA	MARB	TSI					
0.92	0.07	263.30					
Calving Ease	Maternal	Growth	Carcass				
★★★★	★★★★	★★★★	★★★★				
CED	BEPD	WEPD	YEPD	SCR	MILK	MCE	MTNL
4.6	0.9	65	122	1.5	24	0.14	57
BW	Adj. YW	Act. SC	Act. %IMF	IMF Ratio	Act. REA	Act. RibFat	
80	1091	39	3.17	100	13.15	0.12	

125



B3R J006 CONFIDENCE G038

BRADLEY 3 RANCH

Birth Date: 9/5/21 • Bull M966309 • Tattoo: J006 • S

M6 CONFIDENCE 503

B3R F607 CONFIDENCE

M923260

ROR NEXT STEP 702

M6 COOL DANCE 734E P

B3R G038 CCR 734E B008

F1287995

B3R B008 CCR Y029 Z026

• This bull has the number one TSI and YW and Ribeye EPD's in the offering. He gained 3.50#/day on feed with Top 10% WW, Scrotal and Carcass Weight EPD's.

REA	MARB	TSI					
1.11	0.04	265.73					
Calving Ease	Maternal	Growth	Carcass				
★★★★	★★★★	★★★★	★★★★				
CED	BEPD	WEPD	YEPD	SCR	MILK	MCE	MTNL
4.8	1.7	75	128	2.1	23	0.1	60
BW	Adj. YW	Act. SC	Act. %IMF	IMF Ratio	Act. REA	Act. RibFat	
94	936	35.5	3.58	104	10.55	0.09	

126



B3R J002 CONFIDENCE G033

BRADLEY 3 RANCH

Birth Date: 8/29/21 • Bull M966303 • Tattoo: J002 • P

M6 CONFIDENCE 503

B3R F607 CONFIDENCE

M923260

ROR NEXT STEP 702

M6 COOL & STOUT 5106 P ET

B3R G033 M6 5106 C393

F1287607

B3R C393 M6 104 1057 ET

• Homozygous Polled bull that is calving ease with Top 10% CED and Top 25% BW and CEM EPD's. He gained 3.94#/day on grass (#2 in the offering) and 3.48#/day on feed with a Top 10% Ribeye EPD (#3 in the offering).

REA	MARB	TSI					
0.91	0.20	272.75					
Calving Ease	Maternal	Growth	Carcass				
★★★★	★★★★	★★★★	★★★★				
CED	BEPD	WEPD	YEPD	SCR	MILK	MCE	MTNL
8.5	-0.8	67	126	1.4	25	0.1	58
BW	Adj. YW	Act. SC	Act. %IMF	IMF Ratio	Act. REA	Act. RibFat	
72	998	36	3.7	107	10.31	0.14	



LOT 126 B3R J002 CONFIDENCE G033

127



B3R J013 CONFIDENCE G068

BRADLEY 3 RANCH

Birth Date: 9/6/21 • Bull M966313 • Tattoo: J013 • S

M6 CONFIDENCE 503

B3R F607 CONFIDENCE

M923260

ROR NEXT STEP 702

M6 COOL REP 8108 ET

B3R G068 M&M 8108 9525

BF1288369

M&M MS STEALTH 9525 ET

• Add Ribeye with this Top 1% Ribeye EPD (#3 in the offering) he is also #3 in the offering for Maternal with Top 10% WW and YW EPD's that gained 3.45#/day on grass and 4.18#/day on feed. Big scrotal bul; with Top 25% TSI.

REA	MARB	TSI					
1.07	0.01	261.90					
Calving Ease	Maternal	Growth	Carcass				
★★★★	★★★★	★★★★	★★★★				
CED	BEPD	WEPD	YEPD	SCR	MILK	MCE	MTNL
6.8	0.8	74	125	1.7	28	0.09	64
BW	Adj. YW	Act. SC	Act. %IMF	IMF Ratio	Act. REA	Act. RibFat	
87	955	36	2.99	87	9.51	0.11	



LOT 127 & 128 MATERNAL GRANDSIRE M6 COOL REP 8108 ET

128

B3R CONFIDENCE J675

BRADLEY 3 RANCH

Birth Date: 8/27/21 • Bull M967772 • Tattoo: J675 • P



M6 NEW DEAL 246

M6 CONFIDENCE 503
M855467

MR MS STANDARD ISSUE 334

M6 COOL REP 8108 ET

ROR COOL GRADE 814

F1252779

BF MS GAIN & GRADE 440

• Big with a lot of growth. Top 10% WW and YW (#3 in the offering) that gained 3.49#/day on grass and 3.82#/day on feed. He is Top 10% TSI with Top 25% Maternal and CW EPD's.

REA	MARB	TSI	
0.87	0.17	269.62	
Calving Ease	Maternal	Growth	Carcass
★★★★	★★★★	★★★★	★★★★

CED	BEPD	WEPD	YEPD	SCR	MILK	MCE	MTNL
9.0	1.6	75	129	1.3	20	0.15	57
BW	Adj. YW	Act. SC	Act. %IMF	IMF Ratio	Act. REA	Act. RibFat	
93	1205	37	3.67	100	11.73	0.12	



LOT 128 B3R CONFIDENCE J675

129

B3R J613 CONFIDENCE

BRADLEY 3 RANCH

Birth Date: 8/18/21 • Bull M967561 • Tattoo: J613 • P



M6 NEW DEAL 246

M6 CONFIDENCE 503
M855467

MR MS STANDARD ISSUE 334

KAK MR FIREBALL 8D

WITTER CARLI ON FIRE

F1284650

D&D MS CARLI 1510 ET

• Big Good Footed big scrotal bull. He gained 3.82#/day on grass and 3.38#/day on feed with a Top 25% EPD for Ribeye.

REA	MARB	TSI	
0.92	0.10	270.62	
Calving Ease	Maternal	Growth	Carcass
★★★★	★★★★	★★★★	★★★★

CED	BEPD	WEPD	YEPD	SCR	MILK	MCE	MTNL
5.4	1.7	76	132	2.2	21	0.11	59
BW	Adj. YW	Act. SC	Act. %IMF	IMF Ratio	Act. REA	Act. RibFat	
68	1121	42	3.52	100	12.26	0.14	

130

B3R CONFIDENCE J634

BRADLEY 3 RANCH

Birth Date: 8/14/21 • Bull M969124 • Tattoo: J634 • P



M6 NEW DEAL 246

M6 CONFIDENCE 503
M855467

MR MS STANDARD ISSUE 334

M6 ROCK STAR 306 P ET

PC MS ROCK STAR 832

F1278786

PC MS NEW STANDARD 669 P

• Homozygous Polled bull that has the #1 CED and BW EPD's in the offering. He is Top 10% WW and YW EPD's with a 3.17#/day on grass. He is also Top 10% TSI.

REA	MARB	TSI	
0.54	0.18	251.08	
Calving Ease	Maternal	Growth	Carcass
★★★★	★★★	★★★★	★★★★

CED	BEPD	WEPD	YEPD	SCR	MILK	MCE	MTNL
15.4	-3.4	70	110	1.4	18	0.12	53
BW	Adj. YW	Act. SC	Act. %IMF	IMF Ratio	Act. REA	Act. RibFat	
64	977	37.5	3.02	87	11.85	0.07	

131

B3R CONFIDENCE J633

BRADLEY 3 RANCH

Birth Date: 8/1/21 • Bull M969125 • Tattoo: J633 • P



M6 NEW DEAL 246

M6 CONFIDENCE 503
M855467

MR MS STANDARD ISSUE 334

M6 COOL REP 8108 ET

PC MS COOL REP 835 P

F1278771

PC MISS ALTA 303 P

• A lot to like with this Homozygous Polled calving ease bull that gained 3.99#/day on feed. He is Top 10% Scrotal and Top 25% Ribeye.

REA	MARB	TSI	
0.66	0.04	248.76	
Calving Ease	Maternal	Growth	Carcass
★★★★	★★★	★★★★	★★★★

CED	BEPD	WEPD	YEPD	SCR	MILK	MCE	MTNL
14.3	-2.5	53	103	1.6	12	0.14	38
BW	Adj. YW	Act. SC	Act. %IMF	IMF Ratio	Act. REA	Act. RibFat	
69	1108	40	3.19	91	12.38	0.12	

132

B3R CONFIDENCE J635

BRADLEY 3 RANCH

Birth Date: 8/15/21 • Bull M969105 • Tattoo: J635 • P



M6 NEW DEAL 246

M6 CONFIDENCE 503
M855467

MR MS STANDARD ISSUE 334

M6 COOL REP 8108 ET

PC MS COOL REP 365

F1185972

PC MISS DADS RULER ET

• Homozygous Polled Bull that is calving ease with Top 25% EPD's for WW and YW and a 3.74#/day gain on feed.

REA	MARB	TSI	
0.77	0.03	249.64	
Calving Ease	Maternal	Growth	Carcass
★★★★	★★★	★★★★	★★★★

CED	BEPD	WEPD	YEPD	SCR	MILK	MCE	MTNL
12.5	-1.5	64	109	1.5	18	0.15	50
BW	Adj. YW	Act. SC	Act. %IMF	IMF Ratio	Act. REA	Act. RibFat	
80	1157	42.5	3.59	100	13.17	0.11	

133

B3R CONFIDENCE J636

BRADLEY 3 RANCH

Birth Date: 8/23/21 • Bull M969118 • Tattoo: J636 • P



M6 NEW DEAL 246

M6 CONFIDENCE 503
M855467

MR MS STANDARD ISSUE 334

M6 COOL REP 8108 ET

PC MS COOL REP 717

F1254695

PC MISS REAL DEAL 202 P TW

• Guts, Butts and Nuts in this Confidence son that gained 3.62#/day on feed and has a big top with Top 10% RE EPD.

REA	MARB	TSI	
0.72	0.19	250.40	
Calving Ease	Maternal	Growth	Carcass
★★★★	★★★	★★★★	★★★★

CED	BEPD	WEPD	YEPD	SCR	MILK	MCE	MTNL
10.5	0.8	59	106	1.8	9	0.13	38
BW	Adj. YW	Act. SC	Act. %IMF	IMF Ratio	Act. REA	Act. RibFat	
82	1110	42	3.64	106	12.95	0.18	

134

B3R CONFIDENCE J641

BRADLEY 3 RANCH

Birth Date: 9/14/21 • Bull M969128 • Tattoo: J641 • P



M6 NEW DEAL 246

M6 CONFIDENCE 503
M855467

MR MS STANDARD ISSUE 334

M6 BELL RINGER 807

PC MS BELL'S 942 P

F1294607

PC MS NEW STANDARD 627 P

• If you grow them on grass, you will like this Homozygous Polled bull that gained 3.95#/day on grass (#1 in the offering). He is calving ease with big growth and a Top 25% TSI.

REA	MARB	TSI	
0.79	0.17	260.47	
Calving Ease	Maternal	Growth	Carcass
★★★★	★★★	★★★★	★★★★

CED	BEPD	WEPD	YEPD	SCR	MILK	MCE	MTNL
12.5	-2.4	62	114	1.7	18	0.12	49
BW	Adj. YW	Act. SC	Act. %IMF	IMF Ratio	Act. REA	Act. RibFat	
78	1177	37	3.27	97	12.42	0.11	

CHAROLAIS BULLS

135

B3R CONFIDENCE J666

BRADLEY 3 RANCH

Birth Date: 8/25/21 • Bull M969081 • Tattoo: J666 • P



M6 NEW DEAL 246

M6 CONFIDENCE 503
M855467

MR MS STANDARD ISSUE 334

M6 COOL REP 8108 ET

ROR COOL LADY 811

F1252774

ROR AGATHA 062

• You have to like these Confidence sons. Calving ease, big growth, big tops, big scrotals and Top TSI.

REA	MARB	TSI	
0.82	0.11	259.75	
Calving Ease	Maternal	Growth	Carcass
★★★★★	★★★★★	★★★★★	★★★★★

CED	BEPD	WEPD	YEPD	SCR	MILK	MCE	MTNL
10.4	-0.8	70	118	1.6	25	0.15	60
BW	Adj. YW	Act. SC	Act. %IMF	IMF Ratio	Act. REA	Act. RibFat	
75	1003	39	3.8	107	11	0.07	

136

B3R CONFIDENCE J676

BRADLEY 3 RANCH

Birth Date: 9/2/21 • Bull M967773 • Tattoo: J676 • P



M6 NEW DEAL 246

M6 CONFIDENCE 503
M855467

MR MS STANDARD ISSUE 334

M6 RING DA BELL 469 ET

ROR BELLS SMOKE 818 TW

F1254347

PJ MISS MORGAN 5011P

• Last of the Homozygous Polled bulls. He is big growth (Top 10% WW and YW EPD's with big gains on grass and feed. He is also Top 25% TSI.

REA	MARB	TSI	
0.62	0.09	259.47	
Calving Ease	Maternal	Growth	Carcass
★★★★★	★★★★★	★★★★★	★★★★★

CED	BEPD	WEPD	YEPD	SCR	MILK	MCE	MTNL
5.4	1.4	70	121	1.9	14	0.14	50
BW	Adj. YW	Act. SC	Act. %IMF	IMF Ratio	Act. REA	Act. RibFat	
90	1167	40	3.56	97	12.21	0.11	

137

B3R CONFIDENCE J667

BRADLEY 3 RANCH

Birth Date: 9/2/21 • Bull M969082 • Tattoo: J667 • P



M6 NEW DEAL 246

M6 CONFIDENCE 503
M855467

MR MS STANDARD ISSUE 334

M6 COOL REP 8108 ET

ROR COOL LADY 812

F1252778

LS MS GAIN & GRADE 5407 ET

• Last of the Confidence sons that is Polled, calving ease, big growth, big scrotal with a Top 25% TSI.

REA	MARB	TSI	
0.72	0.03	263.28	
Calving Ease	Maternal	Growth	Carcass
★★★★★	★★★★★	★★★★★	★★★★★

CED	BEPD	WEPD	YEPD	SCR	MILK	MCE	MTNL
10.0	-0.1	69	124	1.5	16	0.14	50
BW	Adj. YW	Act. SC	Act. %IMF	IMF Ratio	Act. REA	Act. RibFat	
80	1085	40	3.38	95	10.48	0.09	

138

B3R BELL RINGER J665

BRADLEY 3 RANCH

Birth Date: 8/24/21 • Bull M969080 • Tattoo: J665 • P



M6 RING DA BELL 469 ET

M6 BELL RINGER 807
M904536

M6 MS MADE RIGHT 9147

M6 COOL REP 8108 ET

ROR COOL QUALITY 796

F1238452

ROR QUALITY 841

• Grass growing (3.94 #/day, #2 in the offering), Polled Bull That is Top 10% Scrotal EPD and big topped with Top 25% Ribeye EPD.

REA	MARB	TSI	
0.76	0.16	252.07	
Calving Ease	Maternal	Growth	Carcass
★★★★★	★★★★★	★★★★★	★★★★★

CED	BEPD	WEPD	YEPD	SCR	MILK	MCE	MTNL
7.3	0.2	61	109	0.8	18	0.12	48
BW	Adj. YW	Act. SC	Act. %IMF	IMF Ratio	Act. REA	Act. RibFat	
80	1080	36	3.6	101	12.52	0.11	

139

B3R J603 NEW STANDARD P ET

BRADLEY 3 RANCH

Birth Date: 8/15/21 • Bull EM967178 • Tattoo: J603 • P



LT RIO BRAVO 3181 P

M6 NEW STANDARD 842 P ET
EM756753

M6 MS GRID MAKER 2175 ET

M6 COOL REP 8108 ET

EJS MS COOL DUKE 413 PLD

F1179983

EJS MISS DUKE 9007 PLD

• If you are looking for carcass in a Charolais bull don't miss this one. Top 10% Marbling (#1 in the offering) with Top 10% CW and RE EPD's. This Polled bull also gained 3.60#/day on grass and 4.43#/day on feed with a Top 25% TSI.

REA	MARB	TSI	
1.14	0.22	277.40	
Calving Ease	Maternal	Growth	Carcass
★★★★★	★★★★★	★★★★★	★★★★★

CED	BEPD	WEPD	YEPD	SCR	MILK	MCE	MTNL
2.9	2.0	69	133	2.0	31	0.22	66
BW	Adj. YW	Act. SC	Act. %IMF	IMF Ratio	Act. REA	Act. RibFat	
79	1149	38	3.05	110	14.34	0.12	



LOT 139 B3R J603 NEW STANDARD P ET

140

B3R J601 NEW STANDARD P ET

BRADLEY 3 RANCH

Birth Date: 8/12/21 • Bull EM967176 • Tattoo: J601 • P



LT RIO BRAVO 3181 P

M6 NEW STANDARD 842 P ET
EM756753

M6 MS GRID MAKER 2175 ET

M6 COOL REP 8108 ET

EJS MS COOL DUKE 413 PLD

F1179983

EJS MISS DUKE 9007 PLD

• Full Sib to Lot 20, this Polled bull gained 3.29#/day on grass, has Top 10% Scrotal EPD and Top 25% Milk and Maternal EPD's.

REA	MARB	TSI	
0.51	0.14	233.50	
Calving Ease	Maternal	Growth	Carcass
★★★★★	★★★★★	★★★★★	★★★★★

CED	BEPD	WEPD	YEPD	SCR	MILK	MCE	MTNL
6.7	-0.8	52	90	1.8	25	0.22	51
BW	Adj. YW	Act. SC	Act. %IMF	IMF Ratio	Act. REA	Act. RibFat	
81	1018	42.5	2.49	89	11.63	0.05	

141

B3R J602 NEW STANDARD ET

BRADLEY 3 RANCH

Birth Date: 8/14/21 • Bull EM967177 • Tattoo: J602 • D



LT RIO BRAVO 3181 P

M6 NEW STANDARD 842 P ET
EM756753

M6 MS GRID MAKER 2175 ET

M6 COOL REP 8108 ET

EJS MS COOL DUKE 413 PLD

F1179983

EJS MISS DUKE 9007 PLD

• Full Sib to Lots 20 & 21. Add carcass with Top 25% CW, Marbling and Ribeye EPD's. Growth with 3.70#/day on grass and 3.88#/day on feed. Maternal with Top 25% Milk and Maternal EPD's and Top 25% TSI.

REA	MARB	TSI	
0.73	0.16	247.72	
Calving Ease	Maternal	Growth	Carcass
★★★★★	★★★★★	★★★★★	★★★★★

CED	BEPD	WEPD	YEPD	SCR	MILK	MCE	MTNL
4.9	0.4	60	105	1.5	28	0.21	58
BW	Adj. YW	Act. SC	Act. %IMF	IMF Ratio	Act. REA	Act. RibFat	
83	1041	38	2.22	100	11.66	0.11	

142

B3R J609 PATRIOT

BRADLEY 3 RANCH

Birth Date: 8/24/21 • Bull M967855 • Tattoo: J609 • P



LT LEDGER 0332 P

LT PATRIOT 4004 PLD
M852822

LK MISS RIO 2119

M6 COOL REP 8108 ET

GF COOL NANCY 827

F1256812

M6 MS NEW NANCY 3042P

REA	MARB	TSI	
0.88	0.08	258.36	
Calving Ease	Maternal	Growth	Carcass
★★★★	★★★★	★★★★	★★★★

CED	BEPD	WEPD	YEPD	SCR	MILK	MCE	MTNL
4.8	0.3	71	122	1.3	31	0.22	67
BW	Adj. YW	Act. SC	Act. %IMF	IMF Ratio	Act. REA	Act. RibFat	
76	1152	38	3.18	98	14.02	0.14	

LOT 142 B3R J609 PATRIOT

B3R J421 PATRIOT 601

BRADLEY 3 RANCH

Birth Date: 9/7/21 • Bull M969597 • Tattoo: J421 • P



LT LEDGER 0332 P

LT PATRIOT 4004 PLD
M852822

LK MISS RIO 2119

M6 BELLS & WHISTLES 258 P

MCC MISS WHISTLE 601

F1226156

CJC MS FULL R520

REA	MARB	TSI	
0.51	0.17	250.10	
Calving Ease	Maternal	Growth	Carcass
★★★★	★★★★	★★★★	★★★★

CED	BEPD	WEPD	YEPD	SCR	MILK	MCE	MTNL
4.9	-0.3	64	109	1.0	22	0.21	54
BW	Adj. YW	Act. SC	Act. %IMF	IMF Ratio	Act. REA	Act. RibFat	
94	1097	39	3.28	100	12.57	0.11	

144

B3R J423 PATRIOT 334

BRADLEY 3 RANCH

Birth Date: 9/8/21 • Bull M969585 • Tattoo: J423 • P



LT LEDGER 0332 P

LT PATRIOT 4004 PLD
M852822

LK MISS RIO 2119

TR PZC HOLYWATER 9777 ET

MCC MISS HOLY ONE 334

F1172356

MCC MISS THROTTLE 923

REA	MARB	TSI	
0.84	0.17	272.00	
Calving Ease	Maternal	Growth	Carcass
★★★★	★★★★	★★★★	★★★★

CED	BEPD	WEPD	YEPD	SCR	MILK	MCE	MTNL
5.5	-1.4	58	124	1.0	29	0.21	58
BW	Adj. YW	Act. SC	Act. %IMF	IMF Ratio	Act. REA	Act. RibFat	
88	1140	37.5	3.37	101	13.48	0.16	

LOT 144 B3R J423 PATRIOT 334

145

B3R ALARMS J626

BRADLEY 3 RANCH

Birth Date: 9/14/21 • Bull M967268 • Tattoo: J626 • P



M6 COOL REP 8108 ET

M6 SIRENS & ALARMS 429PS

M849087

M6 MS GAIN & GRADE 552 P

M6 TACTICAL 217 P ET

GF MISS TACTICAL 664

F1220047

GF TANYA 334

REA	MARB	TSI	
0.93	0.12	277.04	
Calving Ease	Maternal	Growth	Carcass
★★★★	★★★★	★★★★	★★★★

CED	BEPD	WEPD	YEPD	SCR	MILK	MCE	MTNL
7.4	-0.6	71	134	1.1	29	0.13	64
BW	Adj. YW	Act. SC	Act. %IMF	IMF Ratio	Act. REA	Act. RibFat	
82	1112	37	3.38	111	11.02	0.14	

LOT 145 B3R ALARMS J626

146

B3R ALARMS J624

BRADLEY 3 RANCH

Birth Date: 9/12/21 • Bull M967266 • Tattoo: J624 • D



M6 COOL REP 8108 ET

M6 SIRENS & ALARMS 429PS

M849087

M6 MS GAIN & GRADE 552 P

M6 WYOMING WIND 4298 PLD

FF MISS WINDY1104 PLD

F1144793

MS OZ ENDURE 3166P

REA	MARB	TSI	
1.25	-0.11	271.11	
Calving Ease	Maternal	Growth	Carcass
★★★★	★★★★	★★★★	★★★★

CED	BEPD	WEPD	YEPD	SCR	MILK	MCE	MTNL
5.6	1.8	68	132	1.2	29	0.13	63
BW	Adj. YW	Act. SC	Act. %IMF	IMF Ratio	Act. REA	Act. RibFat	
83	1053	36.5	2.79	91	13.69	0.11	

B3R COOL HAND J625

BRADLEY 3 RANCH

Birth Date: 9/13/21 • Bull M967267 • Tattoo: J625 • D



M6 COOL REP 8108 ET

M6 COOL HAND 419 ET

EM853148

M6 MS NEW JEWEL 0155 PLD

M6 RANCH HAND 009 P/S

GF BEAUMARK 307

F1162706

ROR MS GAIN & GRADE 5269

REA	MARB	TSI	
1.18	0.15	262.30	
Calving Ease	Maternal	Growth	Carcass
★★★★	★★★★	★★★★	★★★★

CED	BEPD	WEPD	YEPD	SCR	MILK	MCE	MTNL
6.9	-0.1	62	116	1.1	26	0.15	57
BW	Adj. YW	Act. SC	Act. %IMF	IMF Ratio	Act. REA	Act. RibFat	
74	1030	38	2.96	96	14.01	0.14	

CHAROLAIS BULLS

148

B3R J611 REMEDY

BRADLEY 3 RANCH

Birth Date: 8/25/21 • Bull M967856 • Tattoo: J611 • P



LT RUSHMORE 8060 PLD

M6 REMEDY 1803 ET
EM920268

M6/ROR MS JEWEL'S BELL 556 P

M6 TEN STAR 215 P ET

CAREY FRMS ANN MARIE 1827

F1273186

LAFRAISE ANN MARIE 597

• Grow em on grass (3.76#/day) or in the feedyard (3.79#/day). Polled with big scrotal and ribeye.

REA	MARB	TSI	
0.84	0.01	255.67	
Calving Ease	Maternal	Growth	Carcass
★★★★	★★★★	★★★★	★★★★

CED	BEPD	WEPD	YEPD	SCR	MILK	MCE	MTNL
4.7	0.8	70	120	0.6	28	0.12	63
BW	Adj. YW	Act. SC	Act. %IMF	IMF Ratio	Act. REA	Act. RibFat	
83	1152	36	2.89	89	13.87	0.14	



LOT 148 B3R J611 REMEDY

149

B3R HORIZON J639

BRADLEY 3 RANCH

Birth Date: 8/28/21 • Bull M969123 • Tattoo: J639 • H



M6 COOL REP 8108 ET

M6 HORIZON 916 ET
EM932568

LS MS 4247 7628

M6 NEW STANDARD 842 P ET

PC MS NEW STANDARD 829 P

F1278769

PC COOL LADY 156

• Nice big good footed bull that gained 3.13#/day on grass and 3.76#/day on feed. Big scrotal and ribeye. He will work for most herds.

REA	MARB	TSI	
0.67	0.13	234.00	
Calving Ease	Maternal	Growth	Carcass
★★★★	★★★★	★★★★	★★★★

CED	BEPD	WEPD	YEPD	SCR	MILK	MCE	MTNL
5.8	0.0	52	90	1.2	27	0.12	53
BW	Adj. YW	Act. SC	Act. %IMF	IMF Ratio	Act. REA	Act. RibFat	
81	1138	39	3.58	104	13.11	0.11	

150

B3R HORIZON J640

BRADLEY 3 RANCH

Birth Date: 9/9/21 • Bull M969127 • Tattoo: J640 • H



M6 COOL REP 8108 ET

M6 HORIZON 916 ET
EM932568

LS MS 4247 7628

M6 NEW STANDARD 211

PC MS NEW STANDARD 875

F1278778

PC MISS COOL REP 463 P

• Big bull with Top 10% WW EPD and Top 25% Maternal EPD.

REA	MARB	TSI	
0.54	-0.08	239.50	
Calving Ease	Maternal	Growth	Carcass
★★★★	★★★★	★★★★	★★★★

CED	BEPD	WEPD	YEPD	SCR	MILK	MCE	MTNL
-1.9	3.3	67	109	0.9	27	0.11	60
BW	Adj. YW	Act. SC	Act. %IMF	IMF Ratio	Act. REA	Act. RibFat	
88	1082	36	2.83	83	9.62	0.14	



LOT 151 B3R J425 COOL REP 309

151

B3R J425 COOL REP 309

BRADLEY 3 RANCH

Birth Date: 9/10/21 • Bull M969587 • Tattoo: J425 • D



M6 COOL DUDE 6463 P ET

M6 COOL REP 8108 ET
EM770701

SR LADY EASE 914 ET

M&M WYO WIND 8100 P

MCC MISS FUNCTIONAL 309

F1172351

MCC MISS FUNCTION 699

• Big Topped bull with Top 10% Ribeye EPD that gained 3.16#/day on grass and 3.85#/day on feed.

REA	MARB	TSI	
1.04	0.07	254.88	
Calving Ease	Maternal	Growth	Carcass
★★★★	★★★★	★★★★	★★★★

CED	BEPD	WEPD	YEPD	SCR	MILK	MCE	MTNL
3.9	0.9	58	110	1.3	26	0.19	54
BW	Adj. YW	Act. SC	Act. %IMF	IMF Ratio	Act. REA	Act. RibFat	
95	1123	39.5	3.4	102	13.98	0.13	

152

B3R J422 GRID MAKER 508

BRADLEY 3 RANCH

Birth Date: 9/8/21 • Bull M969584 • Tattoo: J422 • P



WCR SIR TRADITION 066

M6 GRID MAKER 104 PET
EM633377

VCR MISS MAC IV 317

LT BLUE VALUE 7903 ET

MISS PARR BLUE VALUE 508

F1220952

MISS PARR BK BABY 201

• Reduce dehorning with this polled bull that will add marbling (Top 25% EPD) to most herds.

REA	MARB	TSI	
0.85	0.21	253.88	
Calving Ease	Maternal	Growth	Carcass
★★★★	★★★★	★★★★	★★★★

CED	BEPD	WEPD	YEPD	SCR	MILK	MCE	MTNL
5.4	0.8	67	112	1.3	33	0.22	66
BW	Adj. YW	Act. SC	Act. %IMF	IMF Ratio	Act. REA	Act. RibFat	
99	1020	38.5	3.14	94	12.41	0.09	

153

B3R J614 RUSHMORE

BRADLEY 3 RANCH

Birth Date: 8/28/21 • Bull M967873 • Tattoo: J614 • P



LT RUSHMORE 8060 PLD

M6/LF RUSHMORE 978
M926460

LAFRAISE MAKENZIE 973

M6 TEN STAR 215 P ET

CAREY FRMS JENNY 1907

F1288278

BULL CAREY FRMS JENNY Y39

• Polled, calving ease bull that gained 3.24#/day on grass and 3.26#/day on feed with big scrotal and ribeye EPD's.

REA	MARB	TSI	
1.03	0.08	258.29	
Calving Ease	Maternal	Growth	Carcass
★★★★	★★★★	★★★★	★★★★

CED	BEPD	WEPD	YEPD	SCR	MILK	MCE	MTNL
5.1	0.2	65	117	0.8	22	0.11	54
BW	Adj. YW	Act. SC	Act. %IMF	IMF Ratio	Act. REA	Act. RibFat	
65	1076	35	3.6	111	14.23	0.13	

154
ACA
B3R J610 ROCK STAR
 BRADLEY 3 RANCH
 Birth Date: 8/24/21 • Bull M967913 • Tattoo: J610 • P

M6 FRESH AIR 8165 P ET
 M6 ROCK STAR 306 P ET
 EM837756
 M6 MS BRAVO GRID 844 ET
 M6 BELLS & WHISTLES 258 P
 M6 VERONICA BELL 6214 P ET
 EF1237117
 WEAVERS RIO VERONICA 1213

• He's polled, big WW EPD gained 3.79#/day on feed will add marbling and big Scrotal.

REA	MARB	TSI	
0.76	0.22	237.34	
Calving Ease	Maternal	Growth	Carcass
★★★★	★★★★	★★★★	★★★★

CED	BEPD	WEPD	YEPD	SCR	MILK	MCE	MTNL
3.6	1.6	62	96	0.8	23	0.16	54
BW	Adj. YW	Act. SC	Act.%IMF	IMF Ratio	Act. REA	Act. RibFat	
89	1038	38	3.08	95	12.46	0.12	





OVIEDO

AUTO GROUP

LA GRANGE, TEXAS









Oviedo Chevrolet GMC
 1910 W. State Hwy 71
 Bypass, La Grange
www.OviedoChevrolet.com

Oviedo Dodge
 1980 W. State Hwy 71
 Bypass, La Grange
www.OviedoDodge.com

TEXAS DROVERS COMMERCIAL HEIFERS

400 Ranch Bred and Raised Commercial Females Sell at Noon!

The 400 Commercial Females will be sold in groups of 5 to 20 head per lot and sorted by consignor, class and pregnancy status. Cattle will be in pens and individually lot tagged and sold via video in their respective groups. Price paid will be asking price times the number in the group sold. Specific lot numbers and group numbers available at sale time.



KAECHELE RANCH COMMERCIAL HEIFERS

KAECHELE RANCH

215 bred 1/4 Brahman black and black baldie 6-8 month bred heifers to low birthweight Brangus bulls. These heifers will be sold in lots of 5 to 20 head.

RED ROCK RANCH

40 bred F-1 Brahman x Angus 3-6 month bred heifers to Angus bulls.

KORBY HALLA

8 bred Brangus type 8 month bred heifers to low birthweight Brangus bulls.

BUNGE HALLA

35 bred 3 yr old E6 6-8 month bred cows to Brangus bulls.

BUNGE HALLA

50 open Black and Baldie 1/4 blood heifers.

LOUEVA AND KEITH HATFIELD

15 open F-1 Brahman x Hereford heifers.

DON JONES

15 pairs Black Baldie 1st calf pairs with Angus calves.

KAECHELE RANCH

35 open Fancy 1/4 Brahman Black and Baldie heifers selling in lots of 5 to 10. Some fancy commercial heifer pen prospects!



KAECHELE RANCH COMMERCIAL HEIFERS



KAECHELE RANCH COMMERCIAL HEIFERS



KAECHELE RANCH COMMERCIAL HEIFERS



- ✓ WESTERN WEAR
- ✓ ANIMAL HEALTH
- ✓ AG PARTS & HARDWARE
- ✓ LAWN & GARDEN
- ✓ COTTON, GRAIN & CATTLE MARKETING SERVICES
- ✓ FENCING & WILDLIFE
- ✓ GRAIN ELEVATORS
- ✓ TIRES & BULK FUEL
- ✓ COTTON GINS & WAREHOUSES
- ✓ PURINA BULK & LIQUID FEED



PURINA

DANEVANG
11338 S. HWY 71
979-543-6723

EDNA
1116 S. WELLS ST.
361-782-5051

EL CAMPO
907 S. WHARTON ST.
979-543-7756

EAGLE LAKE
201 HWY 3013 E.
979-234-2191

WWW.UNITEDAG.NET



Presorted
First Class
US Postage
PAID
SlateGroup

1127 Caroleta Ranch Rd.
Weimar, TX 78962

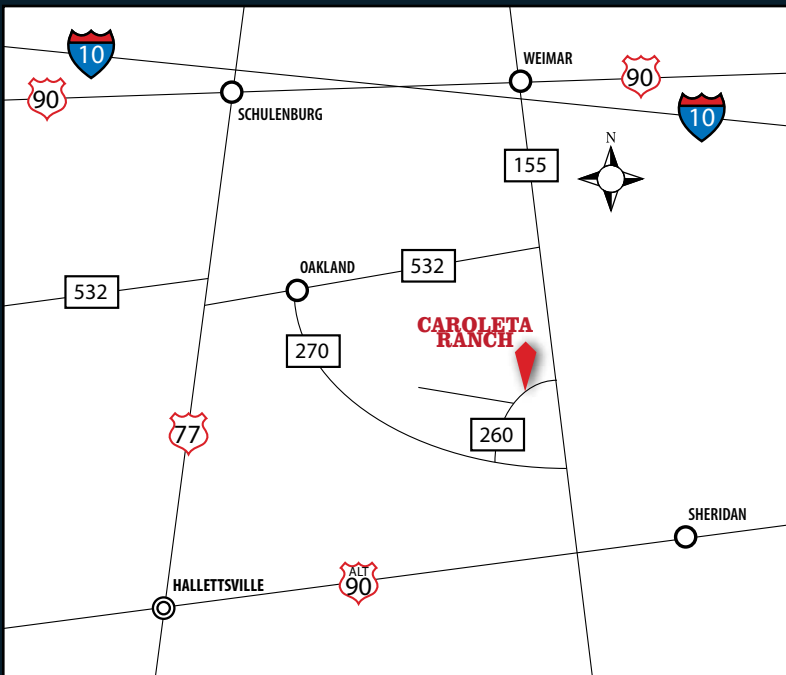

MAP & ADDRESS:

Caroleta Ranch
1127 Caroleta Ranch Rd.
Weimar, TX 78962

